

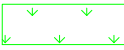





DEMANDE DE PERMIS D'AMENAGER		
Aménagement d'un "camping à la ferme" en "Parc Résidentiel de Loisir" Lieudit "Crussilleux" 69690 BESSENAY	Maître d'ouvrage: M. Didier CHENEVIERE Chemin des Grandes Terres 69690 BESSENAY	Signature:
		Date:
		Echelle: 1/500
PLAN MASSE - PROJET		

-  Emplacements
-  Circulation
-  Stationnements
-  Espace jeux
-  Espace Vert
-  Signalétique, règlement intérieur
-  Bloc sanitaires existant
-  Local poubelles

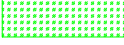
RECAPITULATIF SURFACES	
Emplacements:	5662.4 m²
Circulations:	1530.7 m²
Espaces Verts:	1965.5 m²
Parcelle sanitaires:	223.4 m²
Espace jeux:	258.0 m²
Parkings:	67.2 m²

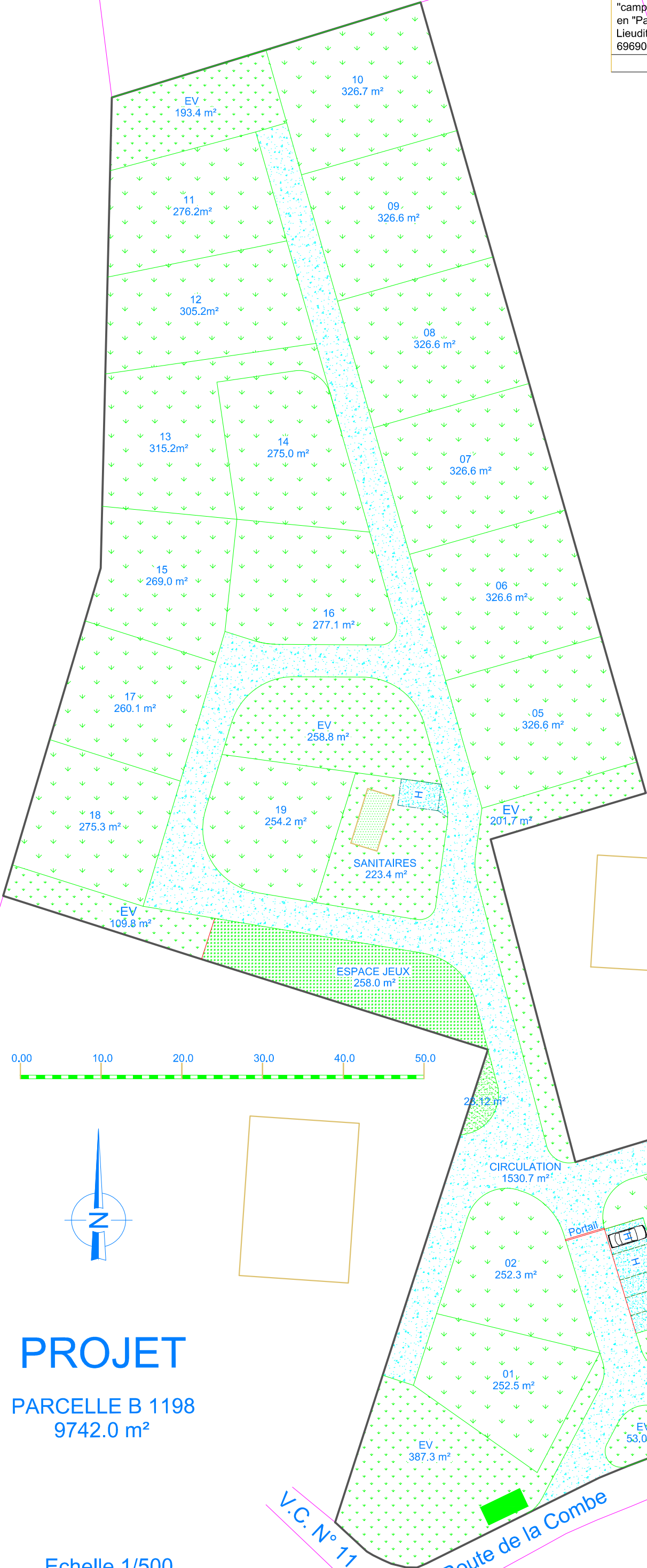

PROJET

PARCELLE B 1198
9742.0 m²

Echelle 1/500