

COMMUNE DE SAINT-LAURENT-SOUS-COIRON
- ARDECHE -

AIRE DE VALORISATION DE L'ARCHITECTURE ET DU PATRIMOINE



DOCUMENT B.2 :
**PLANS REGLEMENTAIRES
A L'ECHELLE DES SECTEURS BATIS**

1/1000e

Mai 2013



Kargo Sud

& Chantal AUSSEUR-DOLLEANS,
Architecte-Urbaniste

LISTE DES SECTEURS BATIS

Sb1 : Le village

Sb2 : Louyre

Sb3 : Solitary

Sb4 : Les Barbes

Sb5 : Comparent

Sb6 : La Fare

Sb7 : Perret 1

Sb8 : Perret 2, 3 et 4

Sb9 : Les Auches

Sb10 : Le Champ de Roland

Sb11 : Lacombe

Sb12 : Dazy

Sb13 : Les Rieux 1 et 2

Sb14 : Les Rieux 3 et 4

Sb15 : Les Rieux 5

Sb16 : Laurenche

Sb17 : Landrau et Guérin 1

Sb18 : Guérin 2 et 3

Sb19 : Villedieu

Sb20 : Marcillac

Sb21 : La Combe Rajeau

Sb22 : Les Blaches

Sb23 : Les Eguyères

Sb24 : Sercinans 3

Sb25 : Sercinans 1 et 2

Sb26 : Boissier

Sb27 : Ladou

Sb28 : Masaulan

Sb1 - Village

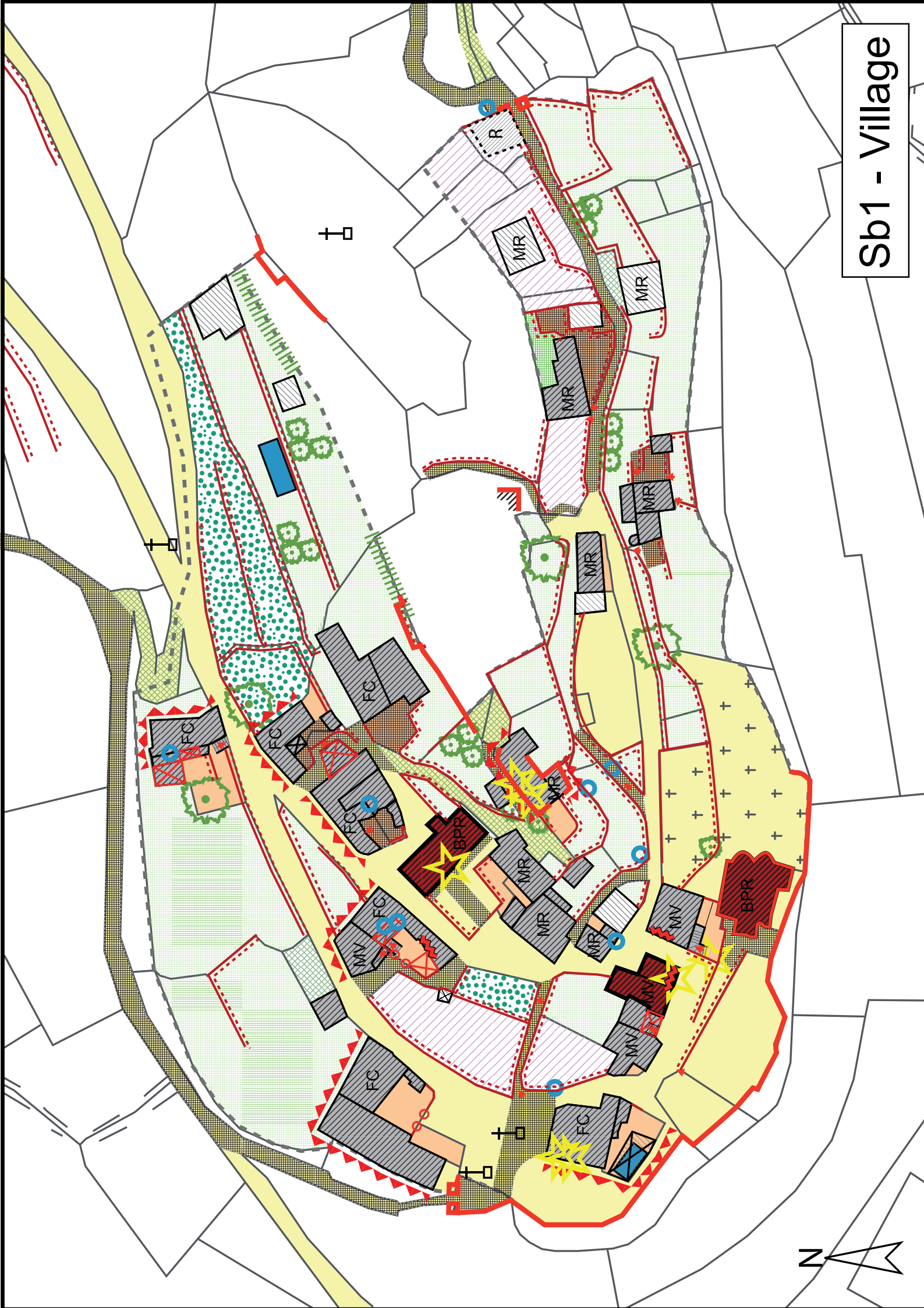

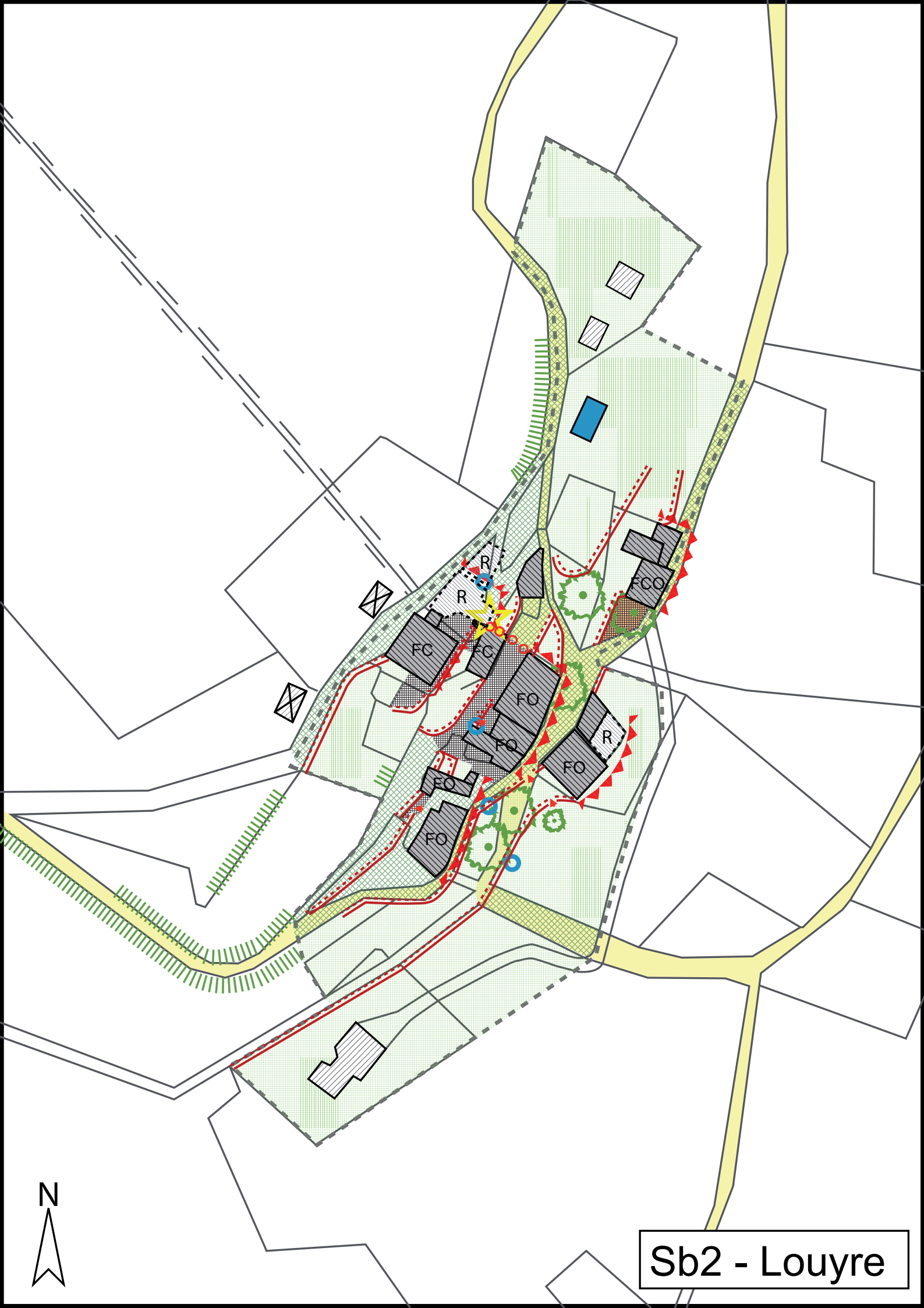

Sb2 - Louyre



Sb3 - Solitary



Sb4 - Les Barbes



Sb5 - Comparent

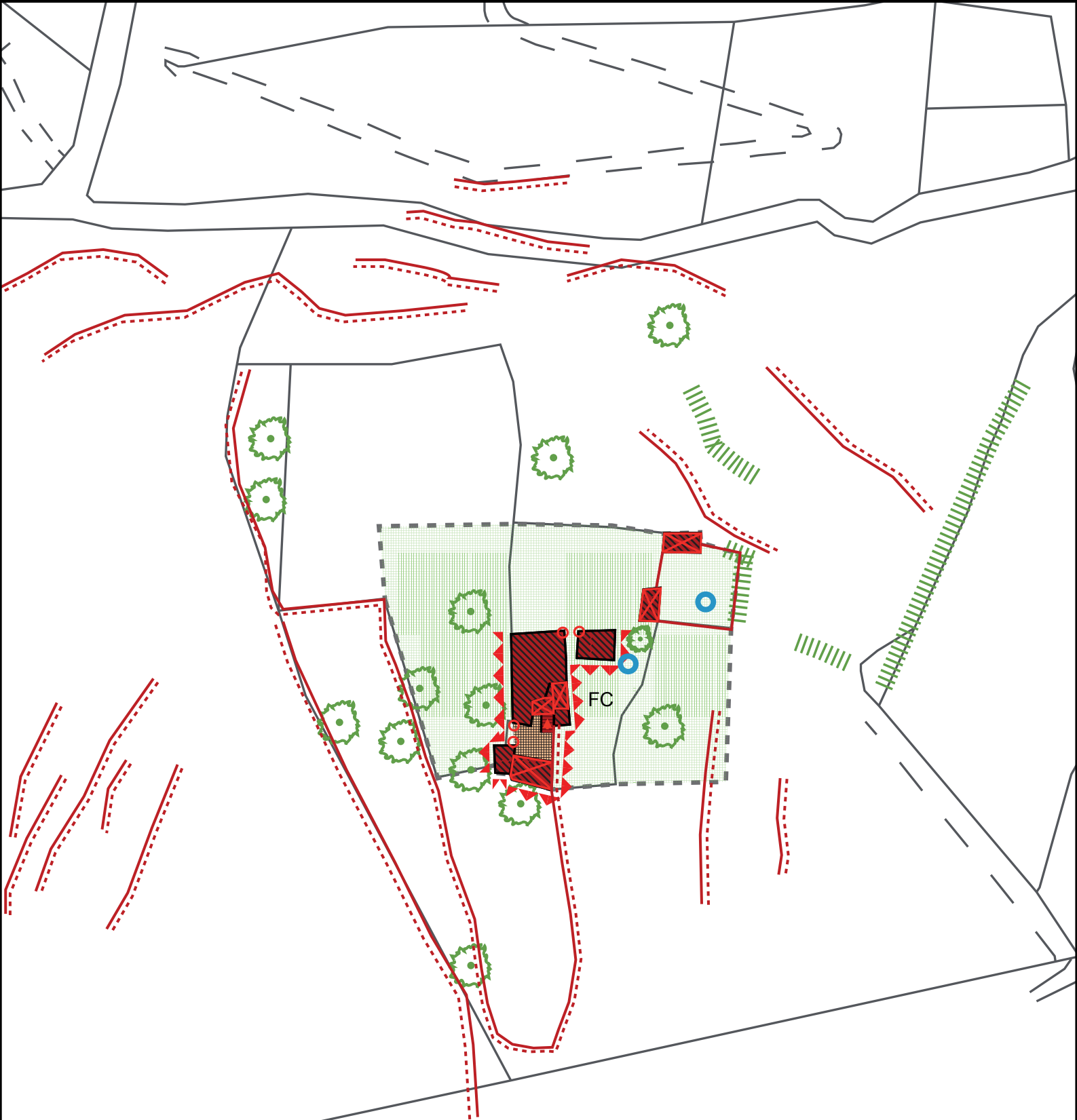

Sb6 - La Fare



FO

1

Sb7 - Perret 1

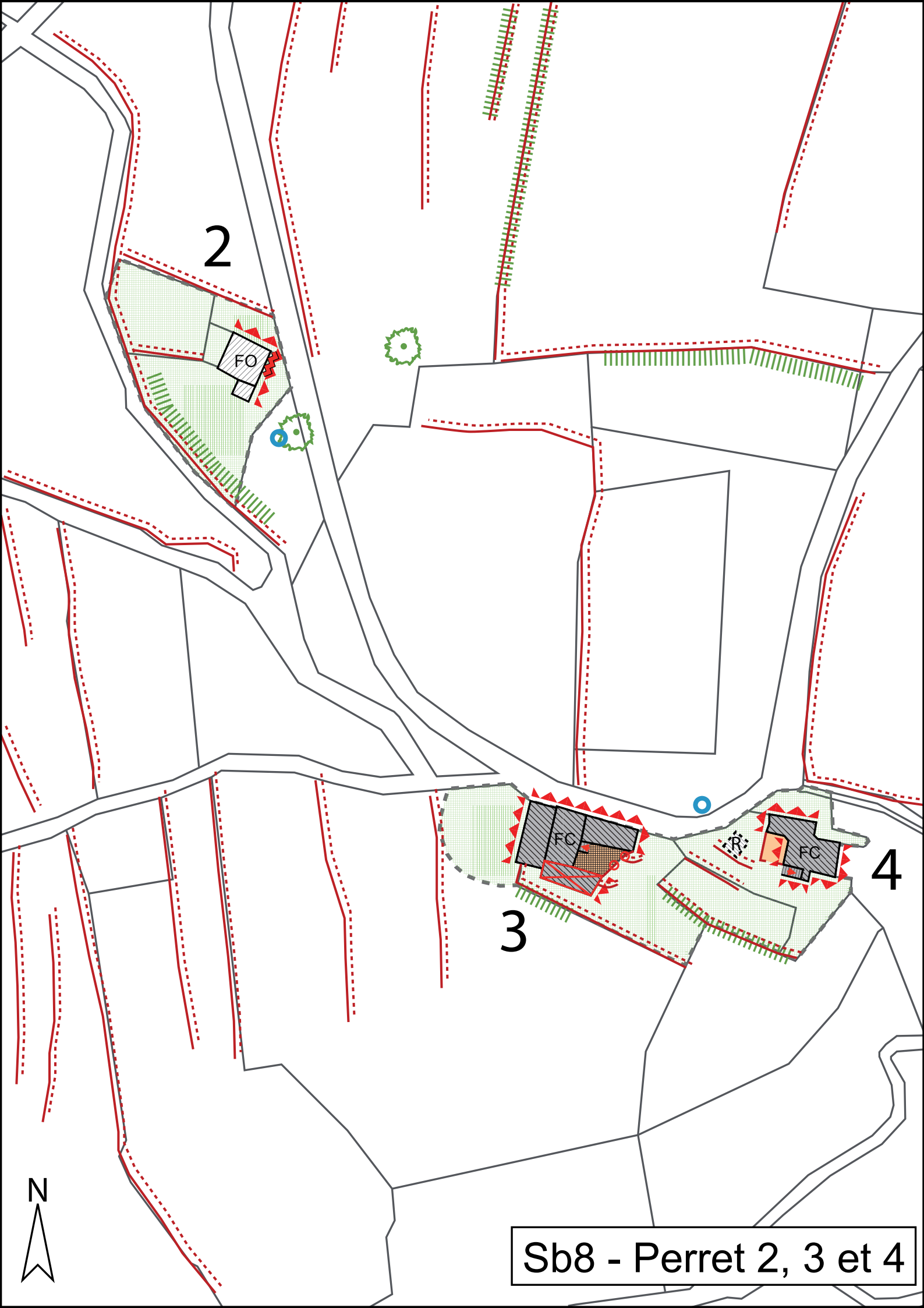

Sb8 - Perret 2, 3 et 4

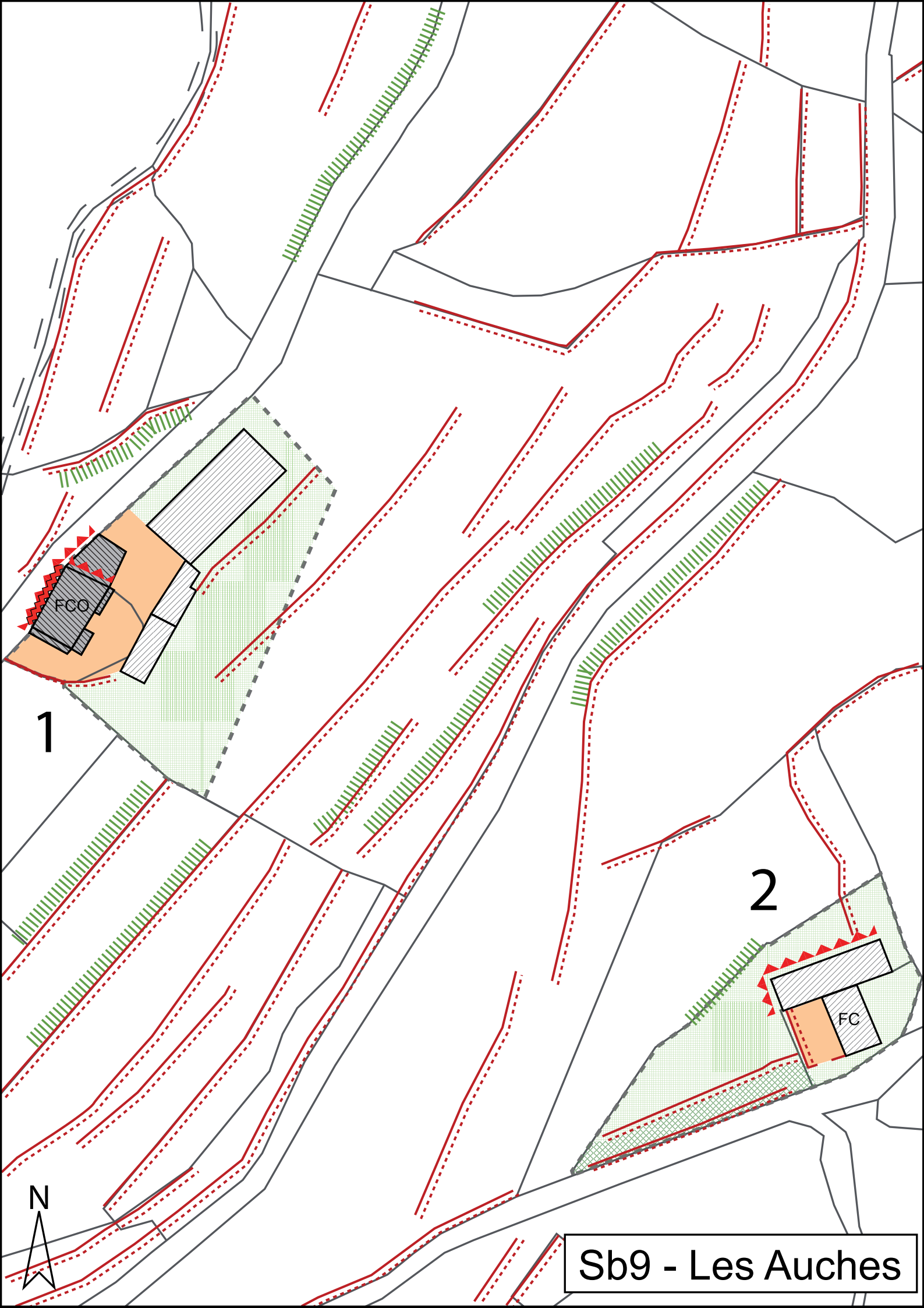

1

2



Sb9 - Les Auches

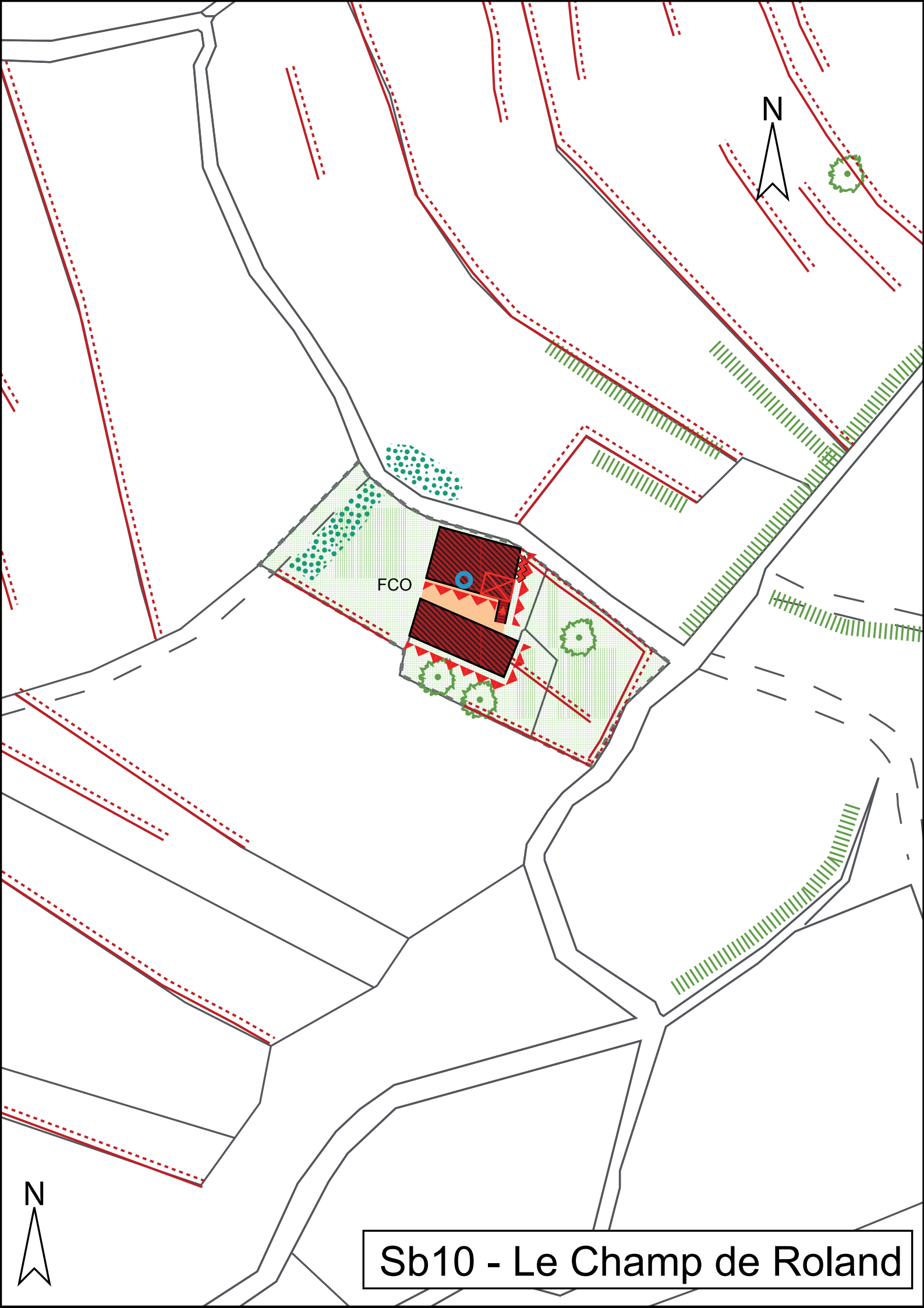

Sb10 - Le Champ de Roland

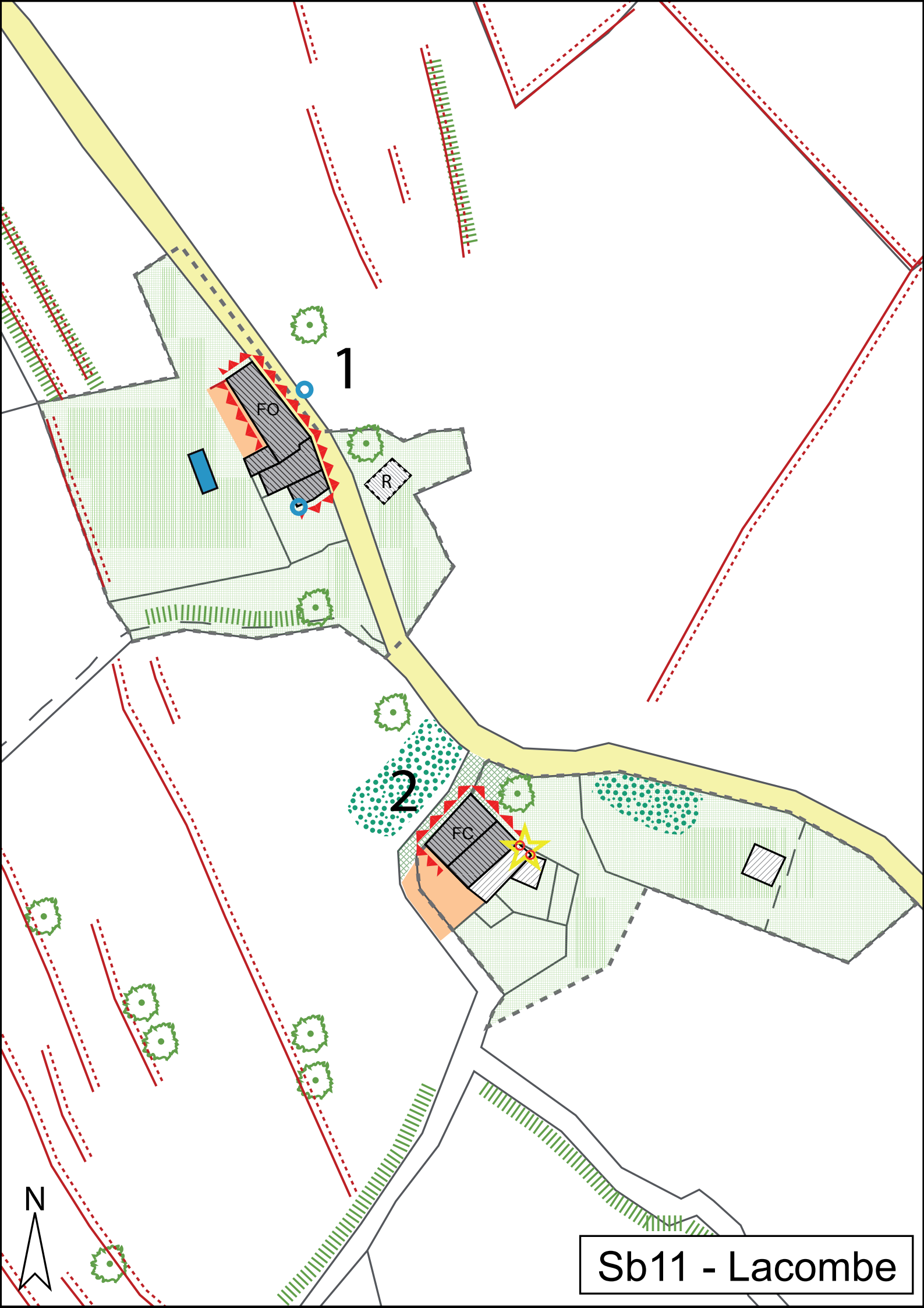

Sb11 - Lacombe



Sb12 - Dazy



Sb13 - Rieux 1 et 2

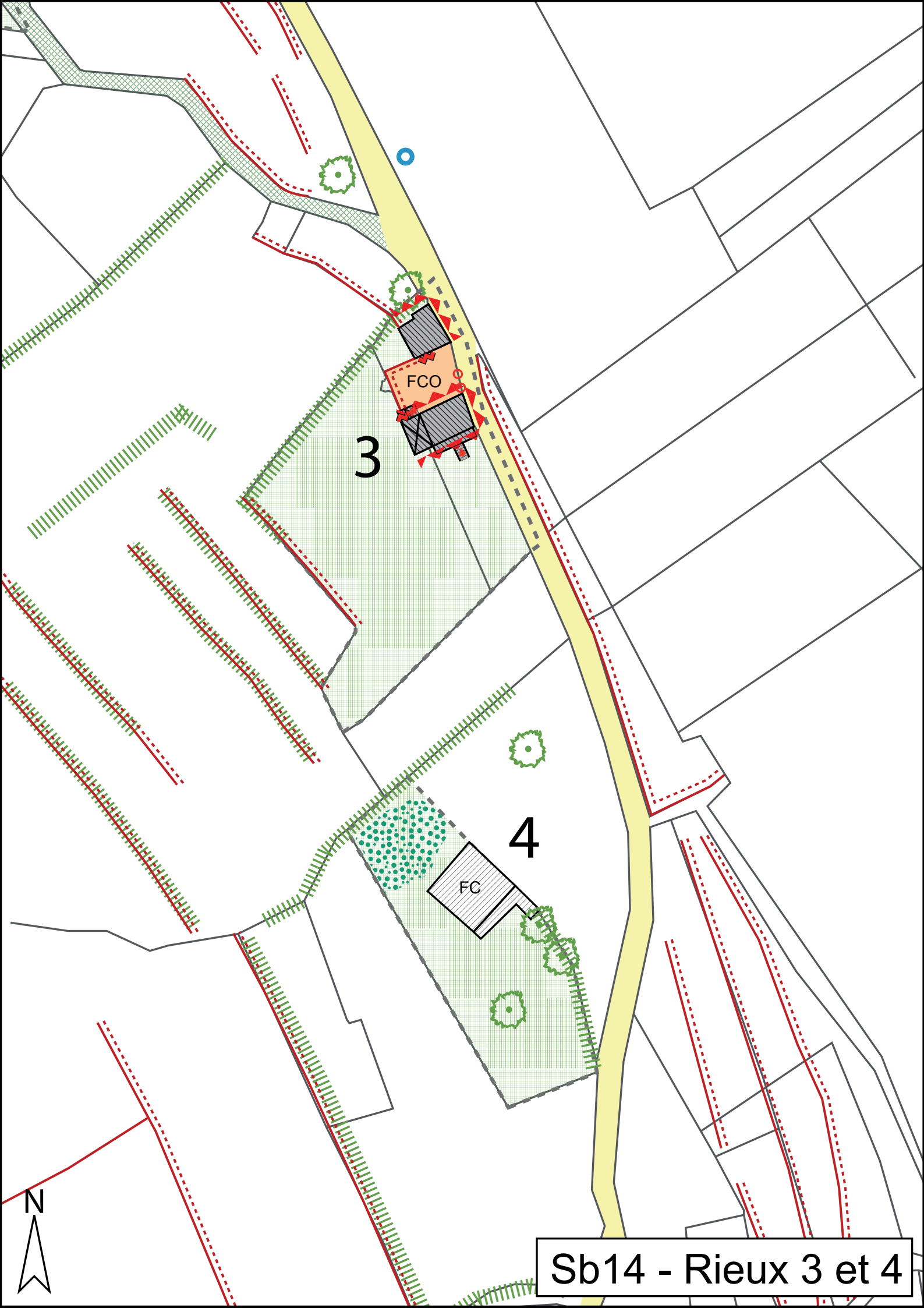

Sb14 - Rieux 3 et 4

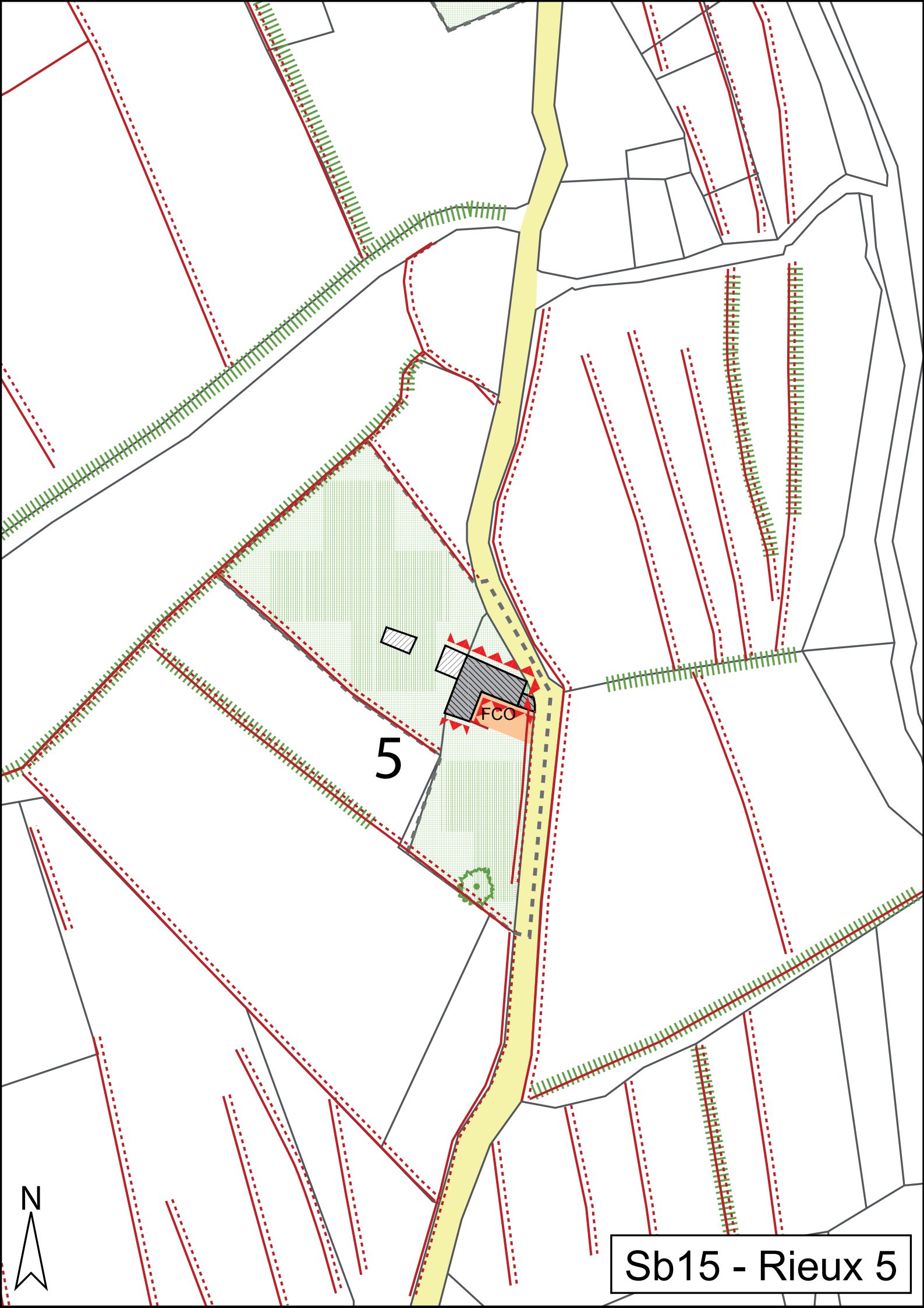

5

FCO

Sb15 - Rieux 5

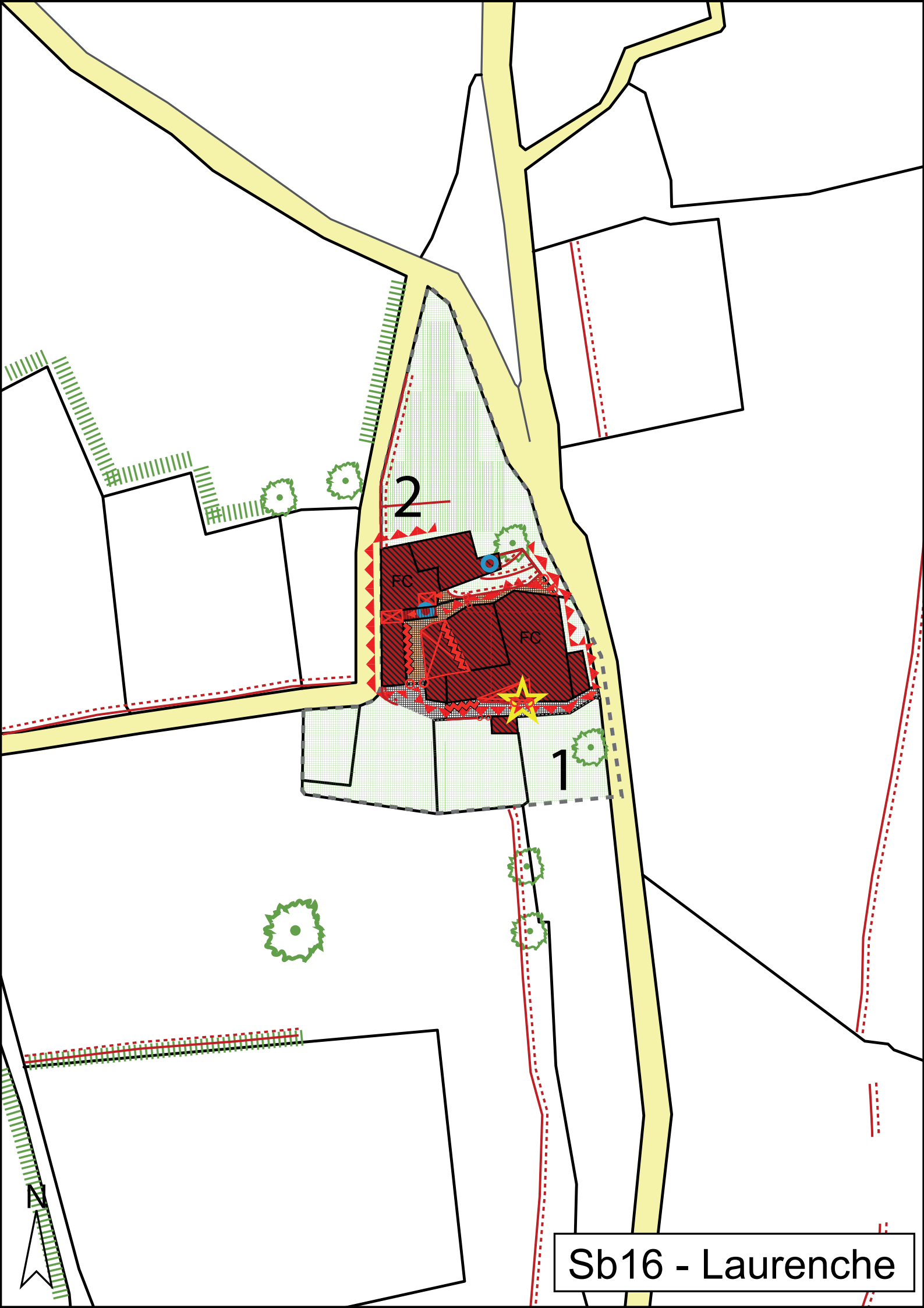

Sb16 - Laurenche

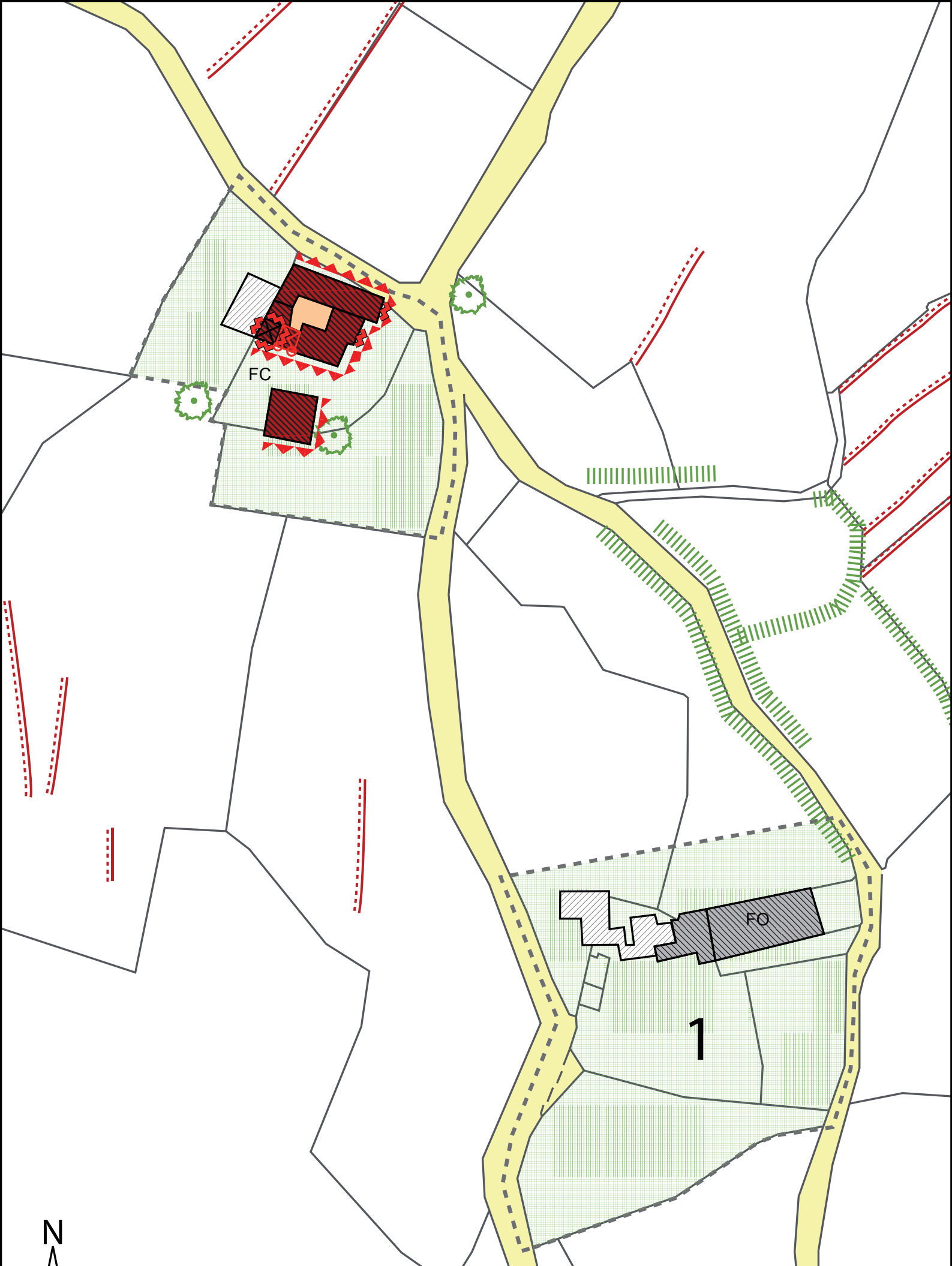

Sb17 - Landrau / Guérin 1

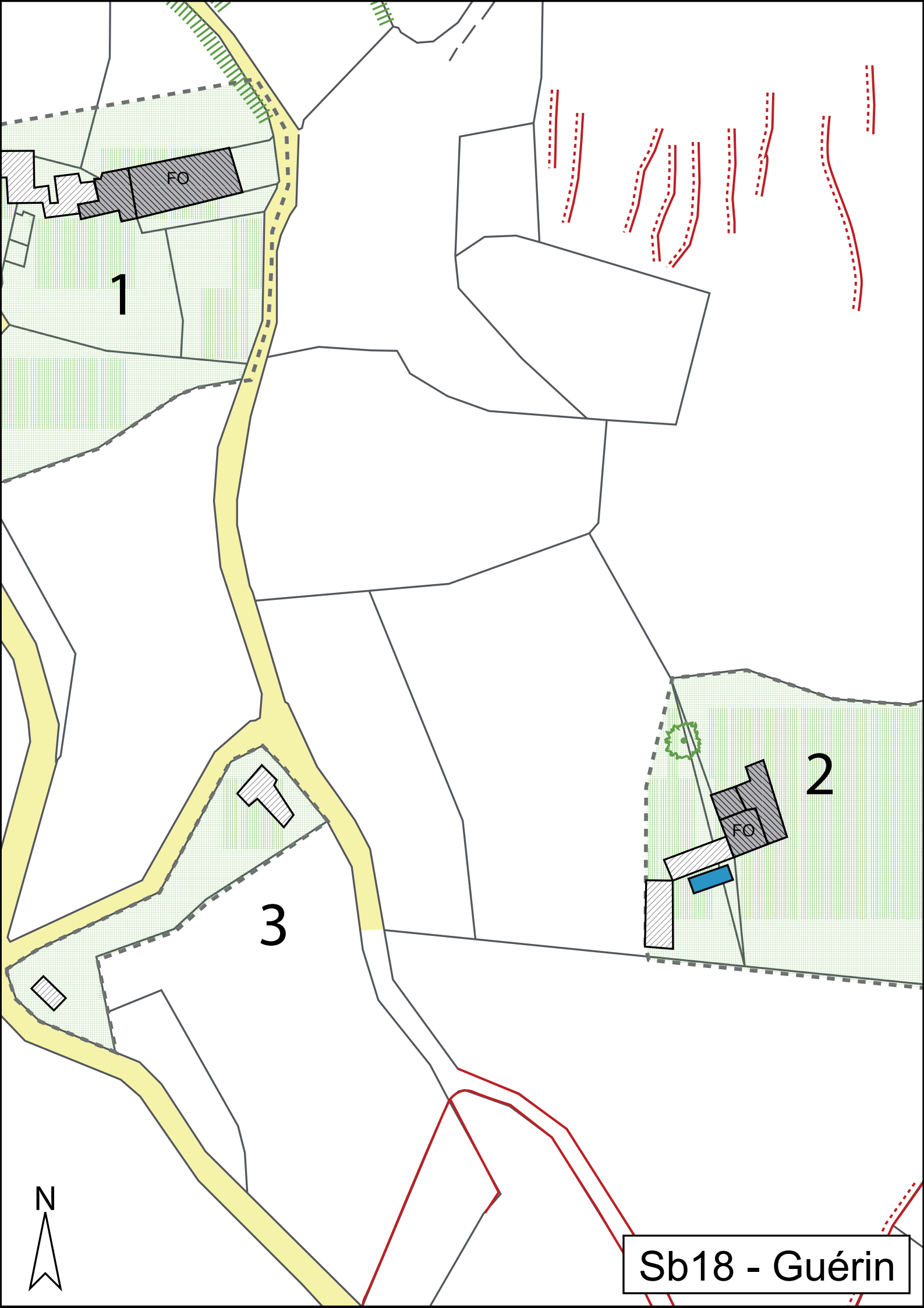

1

2

3

FO

FO

Sb18 - Guérin

N

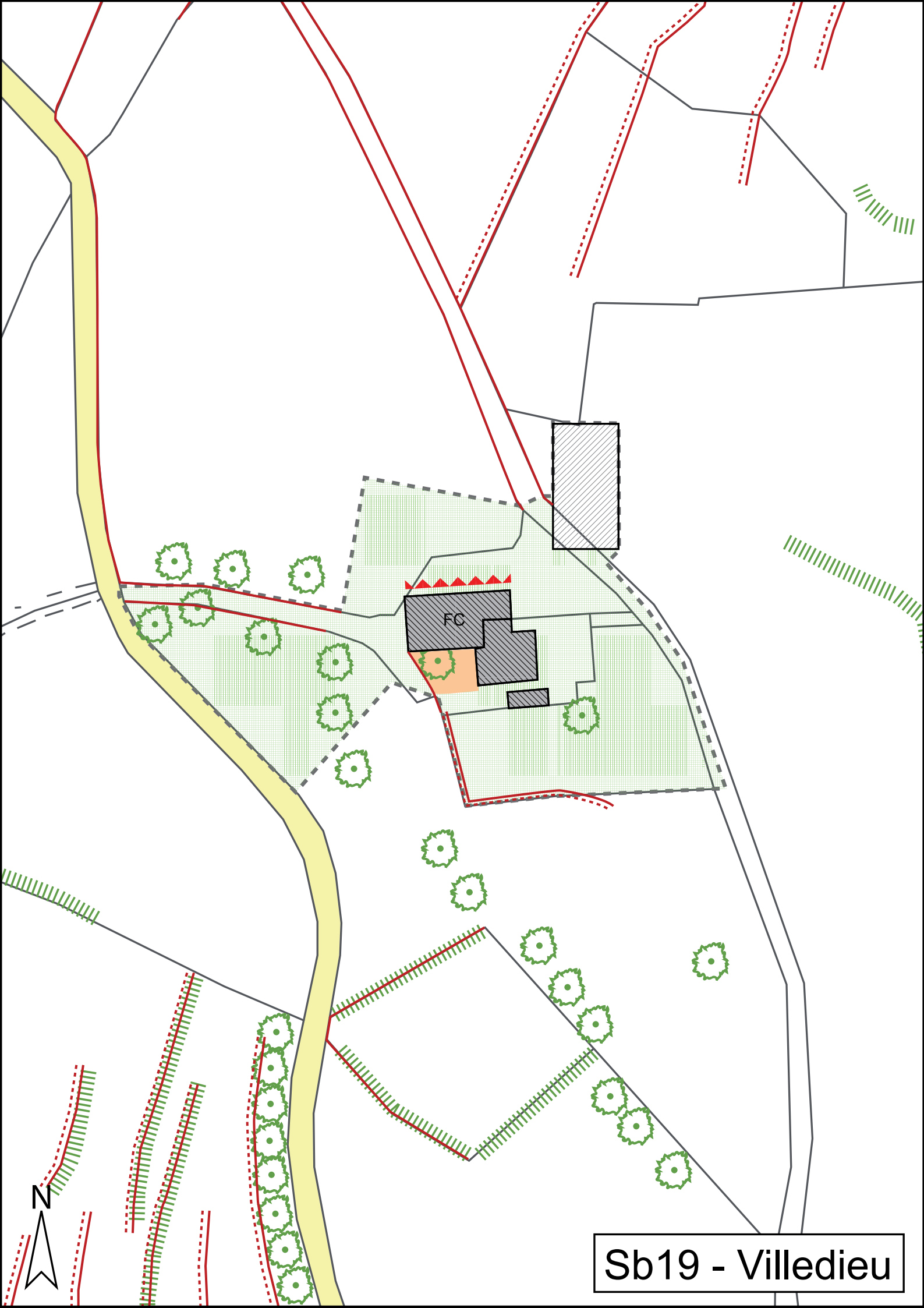

Sb19 - Villedieu

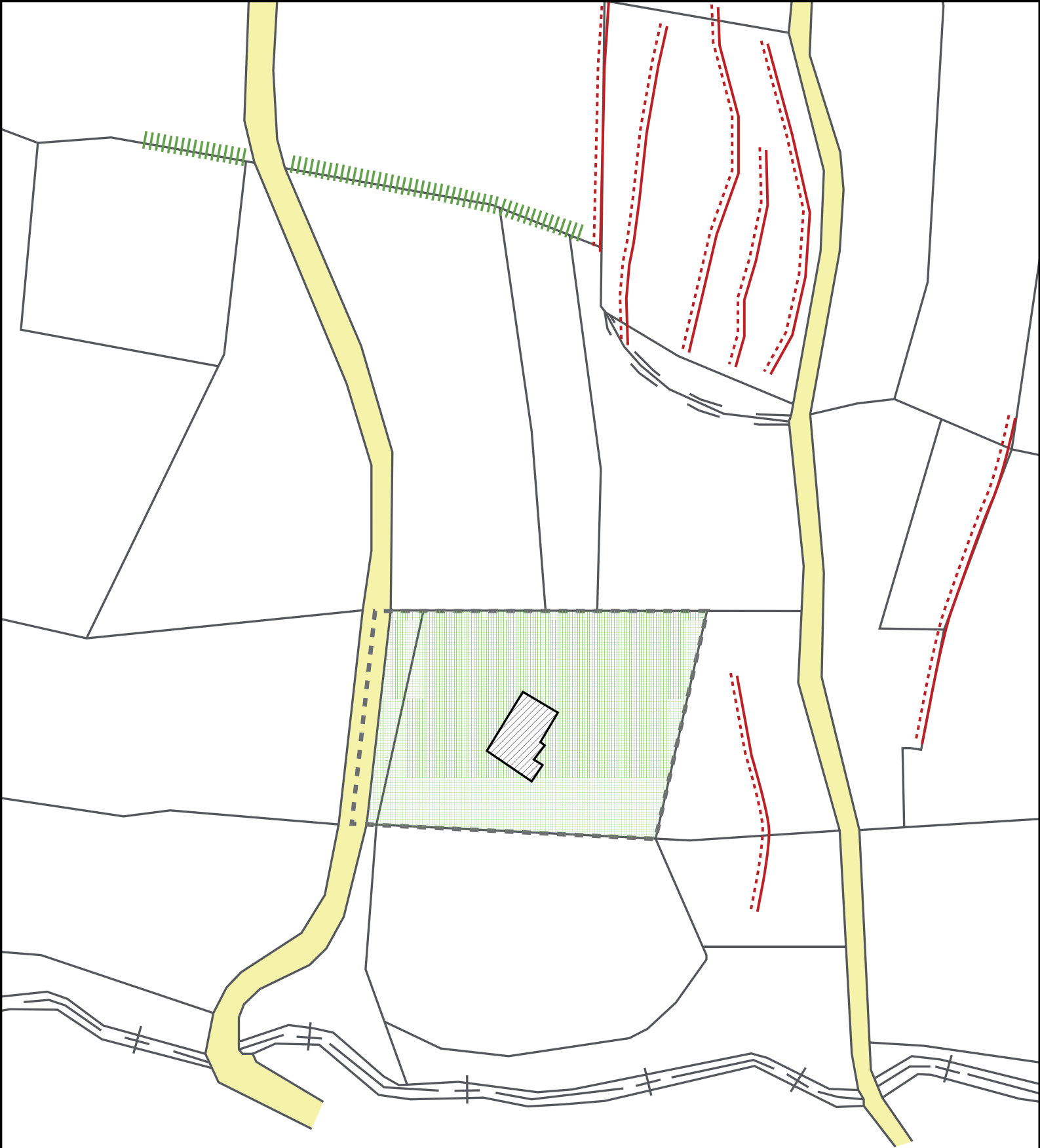

Sb20 - Marcillac

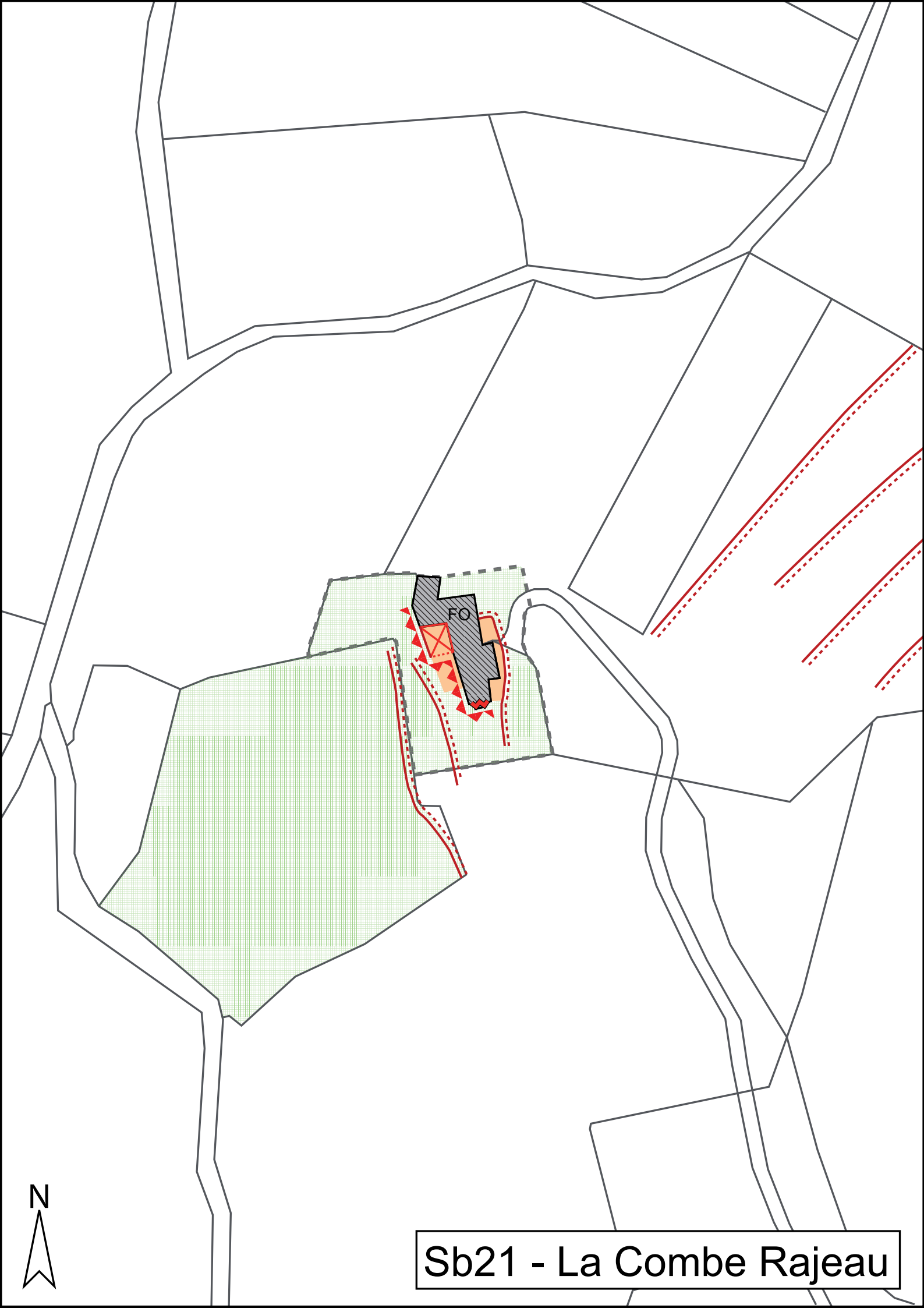

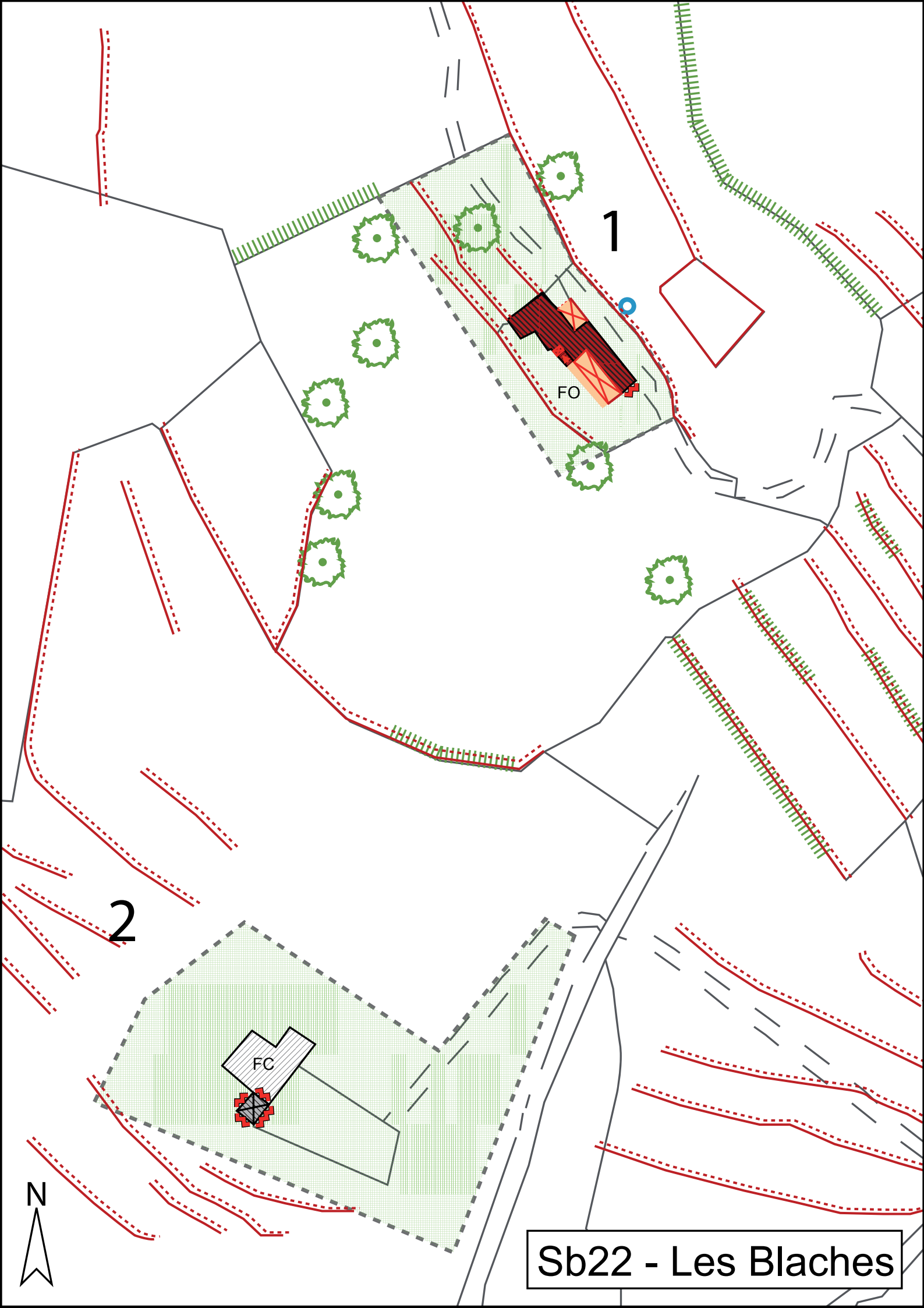

1

FO

2

FC



Sb22 - Les Blaches

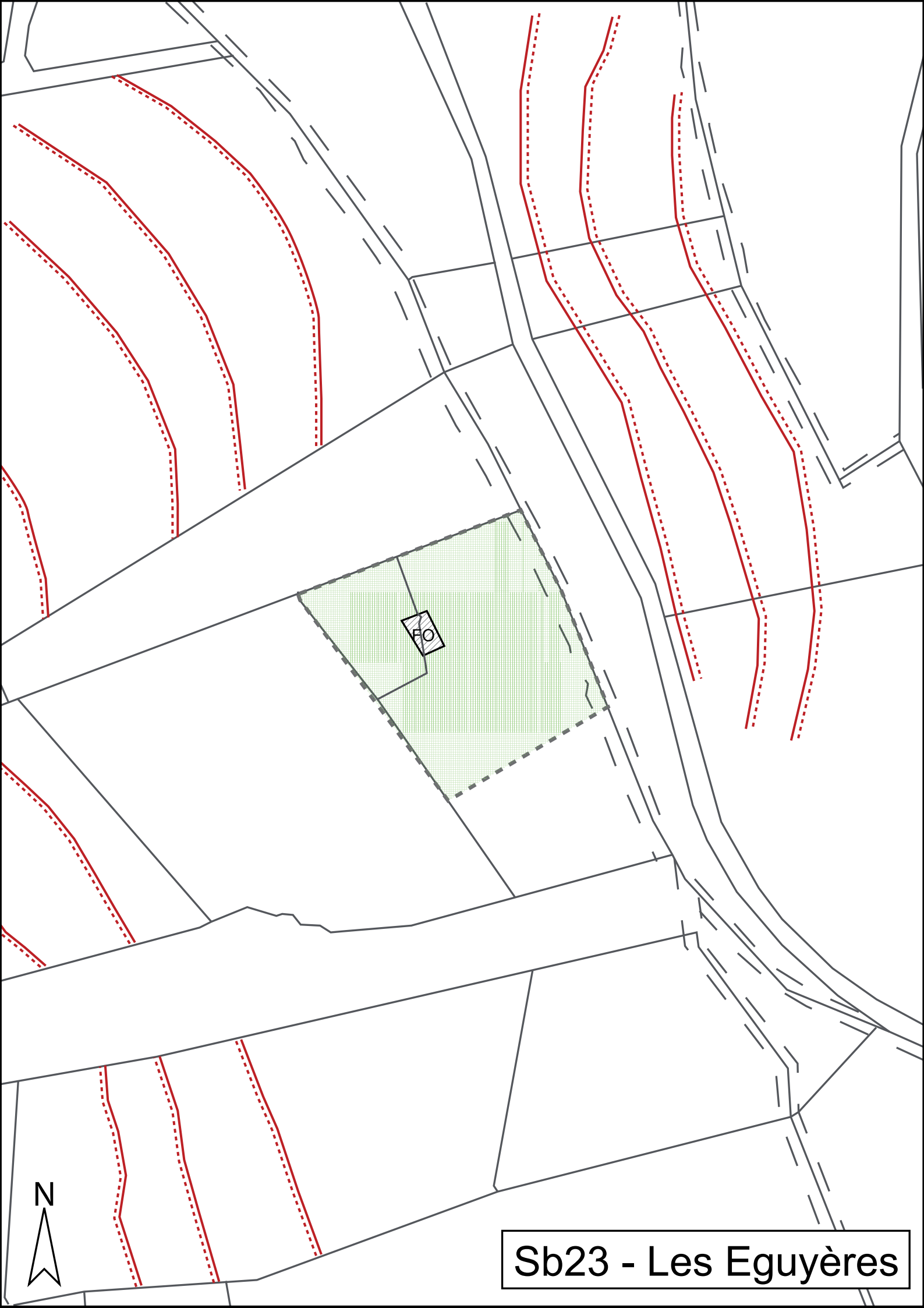

Sb23 - Les Eguyères



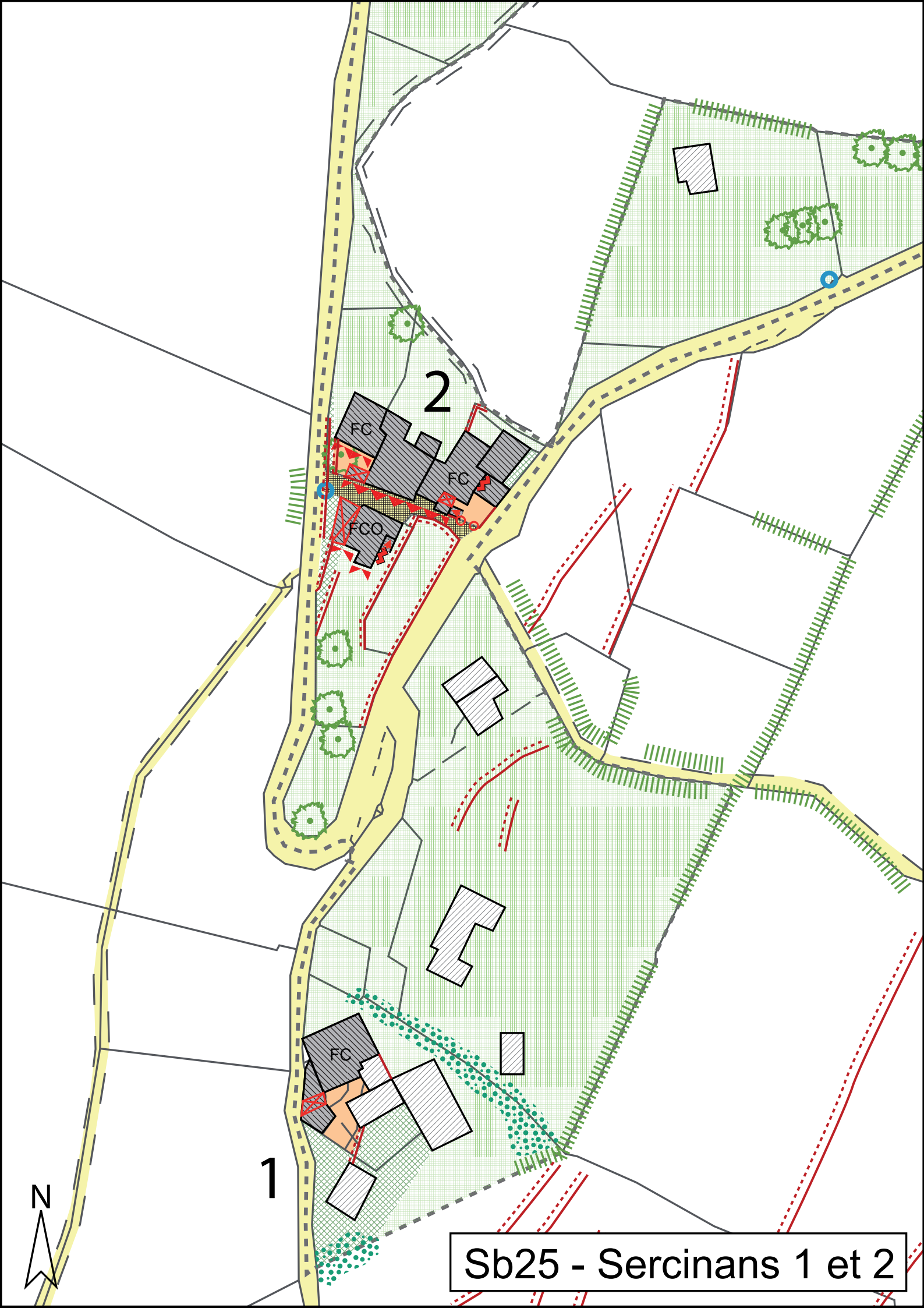

Sb25 - Sercinans 1 et 2

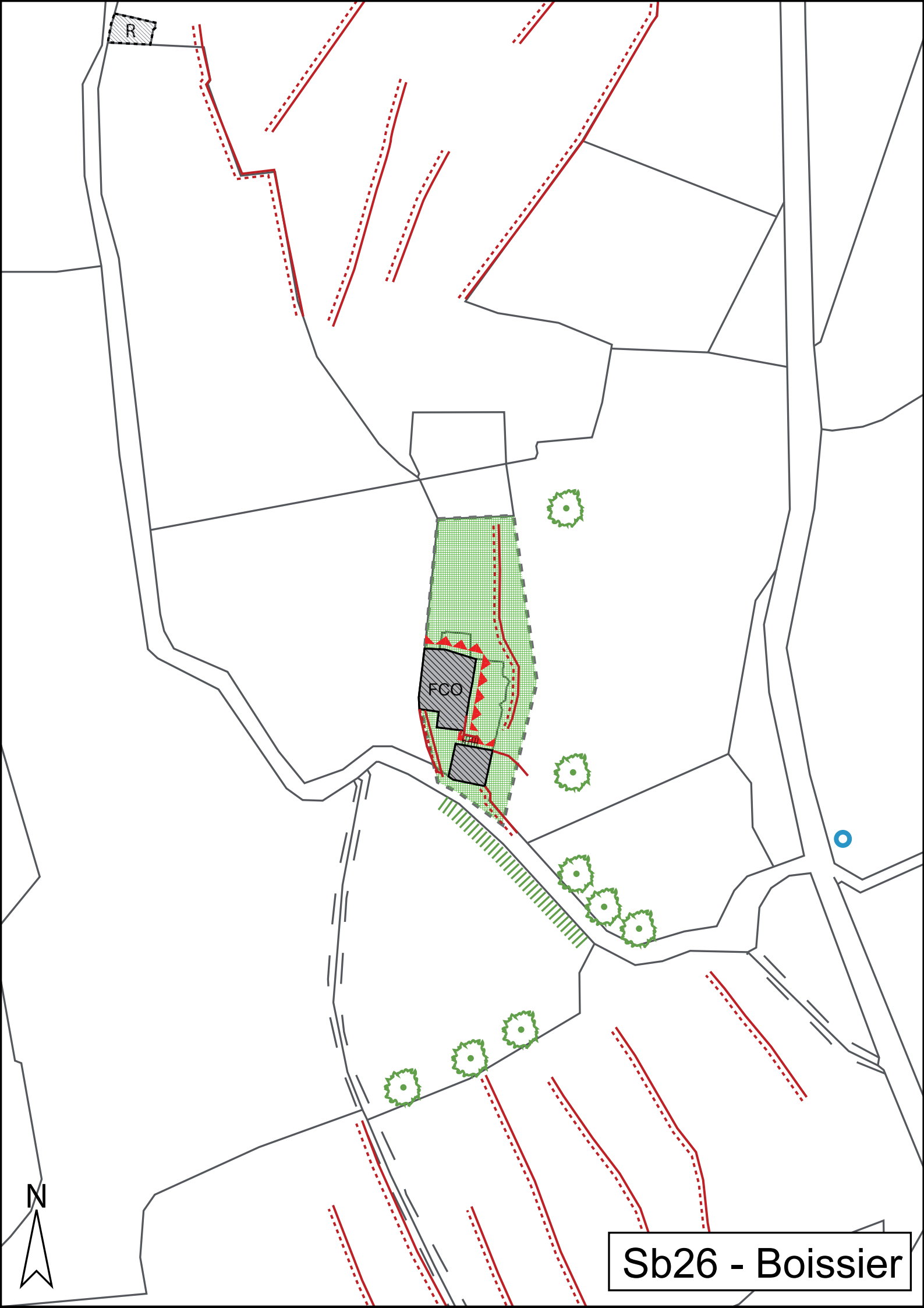

Sb26 - Boissier

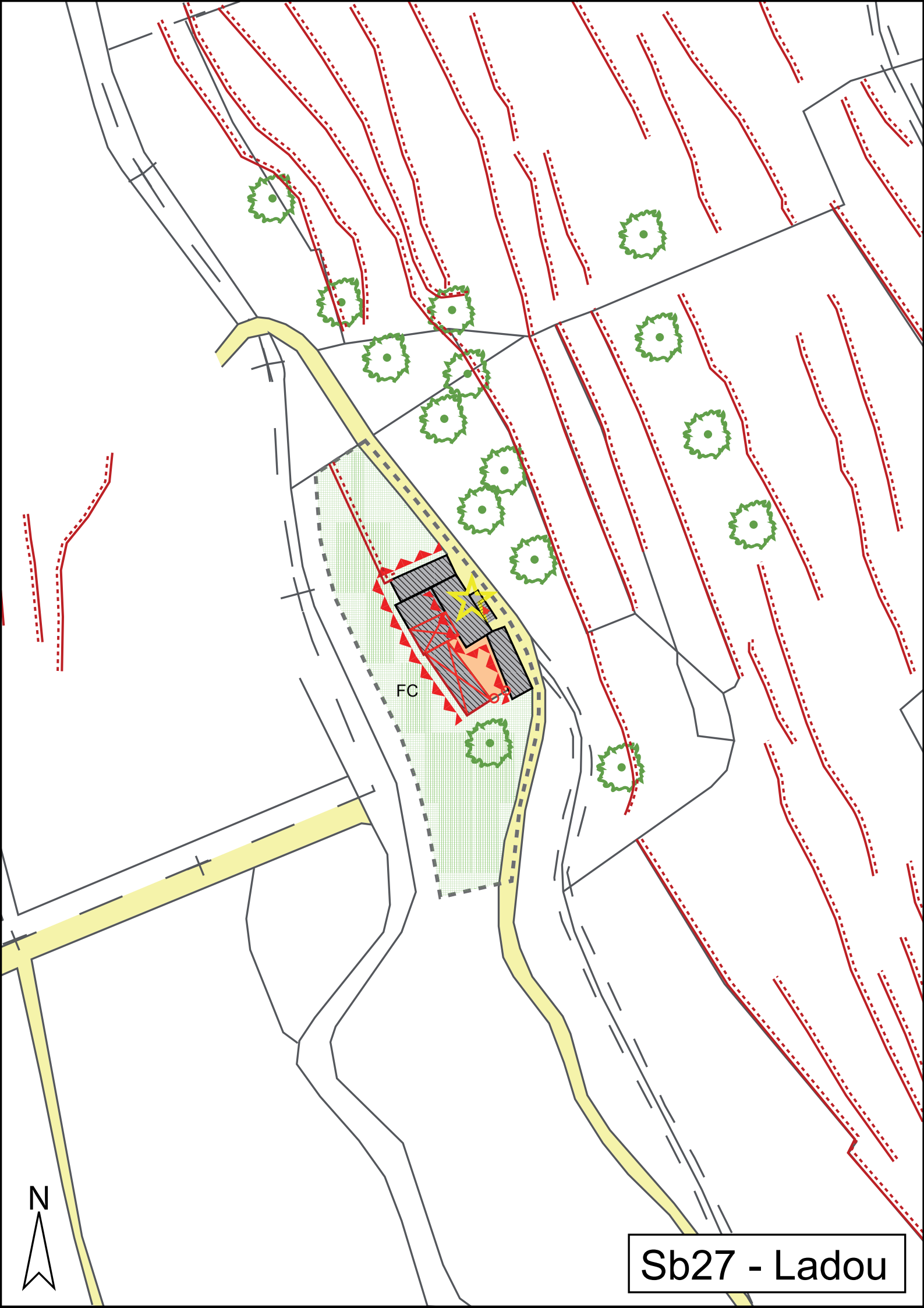

Sb27 - Ladou

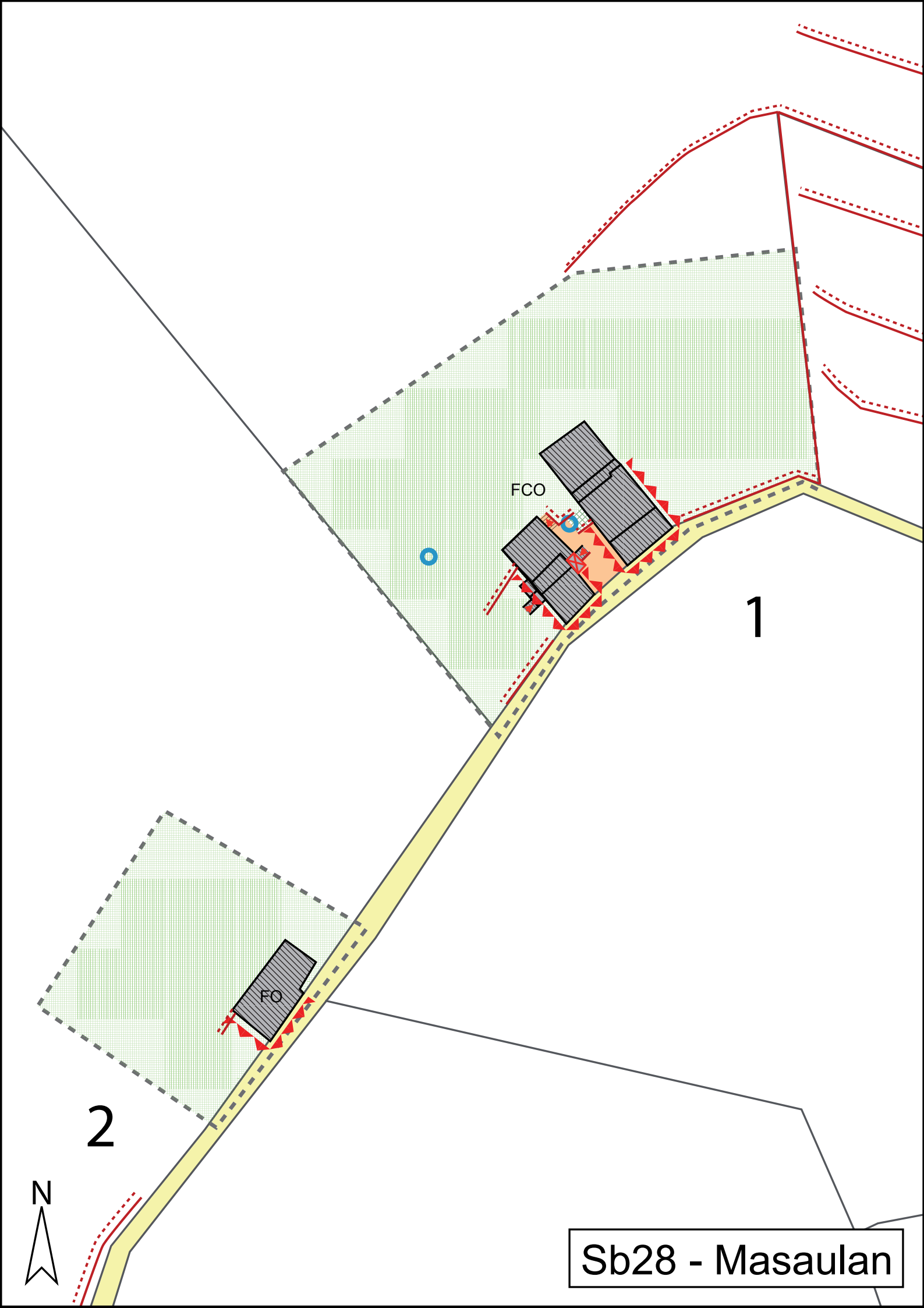

FCO

1

FO

2



Sb28 - Masaulan

