

		CENTRALE DES BOCHERES	
Implantation des ouvrages		Date : 12 10 2018	
		Echelle : 1/5000	
		Plan N°1 rev 0	



Vanne de tête - Conduite Bocheres

Chambre de mise en charge - Conduite Bocheres

Section A  
Section C

955.45 Rive

Relevé le 24/07/2018

954.52  
954.43  
953.85  
953.77  
953.43  
953.46

Torrent "Le VERSOY"

N=954.87

N=954.15

N=953.84

N=954.00

Rive  
Relevé le 24/07/2018

955.00

960.00

Centrale Bonneval

Conduite Bonneval

Conduite Bocheres

Vanne remplissage conduite Bocheres  
et vanne by pass centrale Bonneval avec brise charge

Piquage sur conduite Bonneval

C-388

Chemin

963.20

963.16

963.08

963.08

Chemin

962.69 / S.8  
963.15  
963.19

Ve

963.97

964.10

963.78

963.72

963.28

963.47

959.19

960.32

960.54

961.74

962.56

962.67

962.79

962.58

962.56

961.74

962.58

962.56

962.58

962.56

962.58

959.00

958.71

958.83

958.81

958.89

958.89

958.89

958.89

958.89

958.89

958.89

958.89

958.89

958.89

958.89

958.89

958.89

958.89

958.89

958.79

958.94

958.95

958.81

958.81

958.81

958.81

958.81

958.81

958.81

958.81

958.81

958.81

958.81

958.81

958.81

958.81

958.81

958.81

958.75

958.83

958.81

958.81

958.81

958.81

958.81

958.81

958.81

958.81

958.81

958.81

958.81

958.81

958.81

958.81

958.81

958.81

958.81

958.79

958.94

958.95

958.81

958.81

958.81

958.81

958.81

958.81

958.81

958.81

958.81

958.81

958.81

958.81

958.81

958.81

958.81

958.81

958.75

958.83

958.81

958.81

958.81

958.81

958.81

958.81

958.81

958.81

958.81

958.81

958.81

958.81

958.81

958.81

958.81

958.81

958.81

958.79

958.94

958.95

958.81

958.81

958.81

958.81

958.81

958.81

958.81

958.81

958.81

958.81

958.81

958.81

958.81

958.81

958.81

958.81

958.75

958.83

958.81

958.81

958.81

958.81

958.81

958.81

958.81

958.81

958.81

958.81

958.81

958.81

958.81

958.81

958.81

958.81

958.81

958.79

958.94

958.95

958.81

958.81

958.81

958.81

958.81

958.81

958.81

958.81

958.81

958.81

958.81

958.81

958.81

958.81

958.81

958.81

958.75

958.83

958.81

958.81

958.81

958.81

958.81

958.81

958.81

958.81

958.81

958.81

958.81

958.81

958.81

958.81

958.81

958.81

958.81

958.79

958.94

958.95

958.81

958.81

958.81

958.81

958.81

958.81

958.81

958.81

958.81

958.81

958.81

958.81

958.81

958.81

958.81

958.81

958.75

958.83

958.81

958.81

958.81

958.81

958.81

958.81

958.81

958.81

958.81

958.81

958.81

958.81

958.81

958.81

958.81

958.81

958.81

958.79

958.94

958.95

958.81

958.81

958.81

958.81

958.81

958.81

958.81

958.81

958.81

958.81

958.81

958.81

958.81

958.81

958.81

958.81

958.75

958.83

958.81

958.81

958.81

958.81

958.81

958.81

958.81

958.81

958.81

958.81

958.81

958.81

958.81

958.81

958.81

958.81

958.81

958.79

958.94

958.95

958.81

958.81

958.81

958.81

958.81

958.81

958.81

958.81

958.81

958.81

958.81

958.81

958.81

958.81

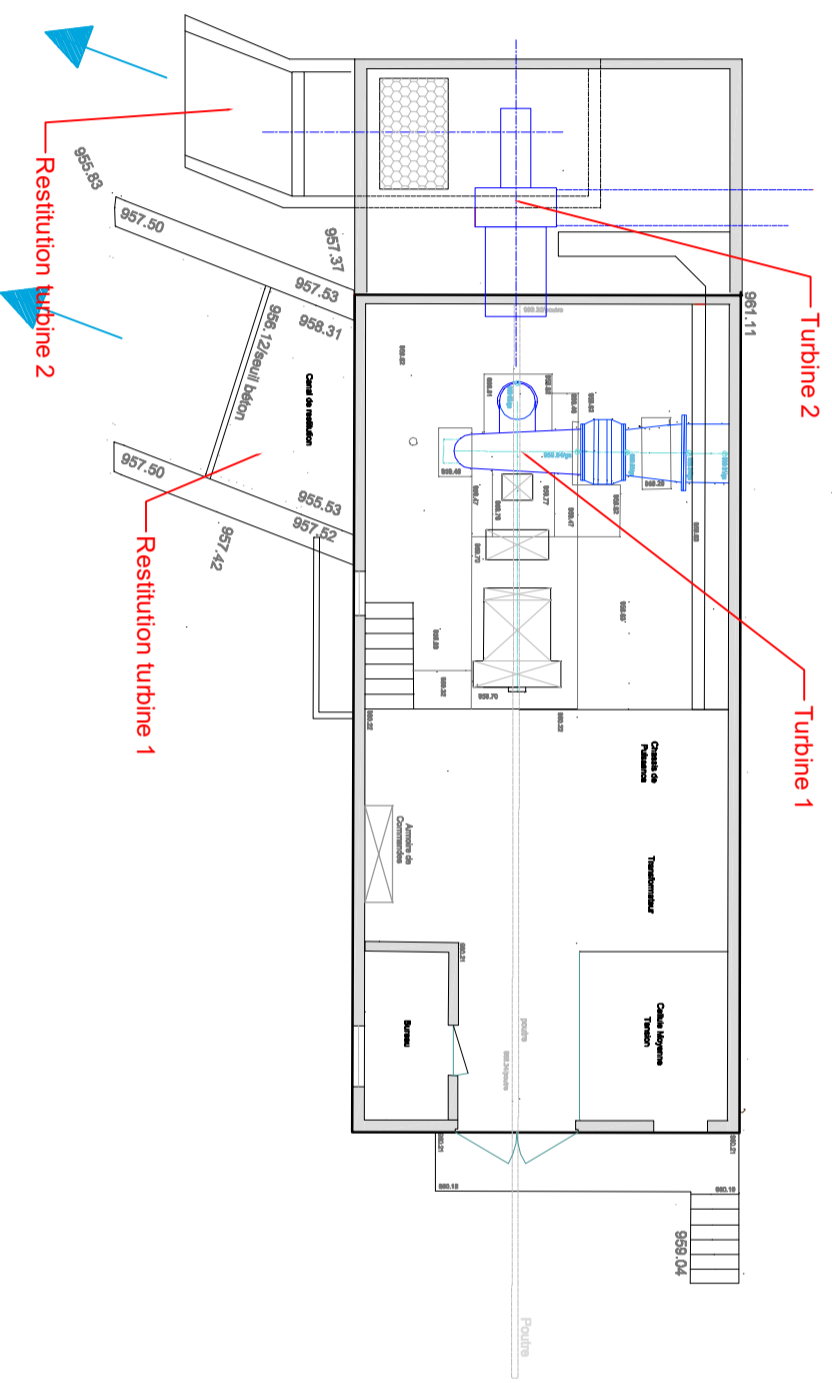

Centrale actuelle de Bonneval

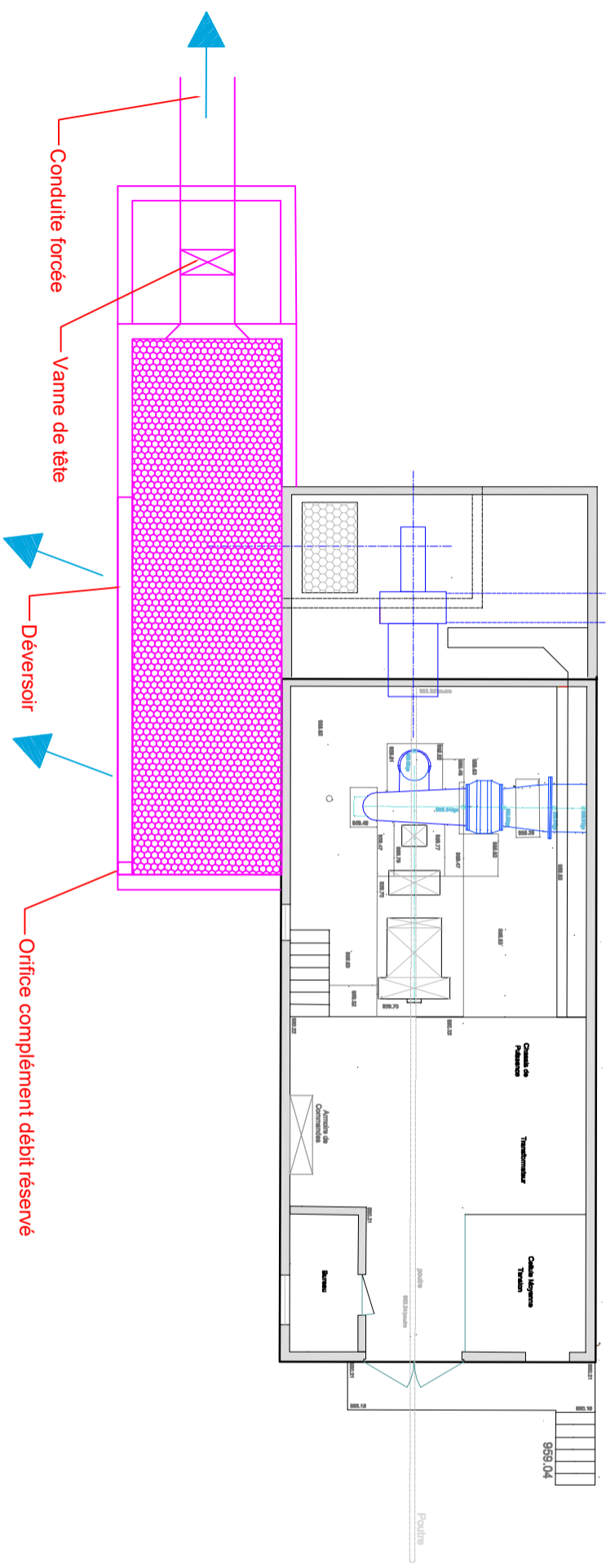

Centrale de Bonneval et chambre de mise en charge

CENTRALE DES BOCHERES		Date : 12 10 2018
Chambre de mise en charges		Echelle : 1/125
Vue de dessus		Plan N°3 rev 0

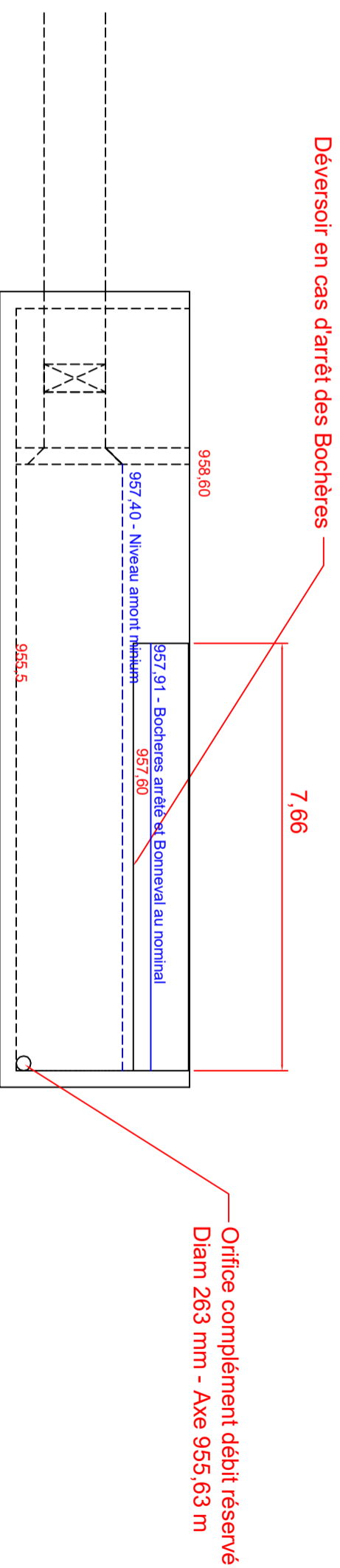

Chambre de mise en charge - Vue de coté

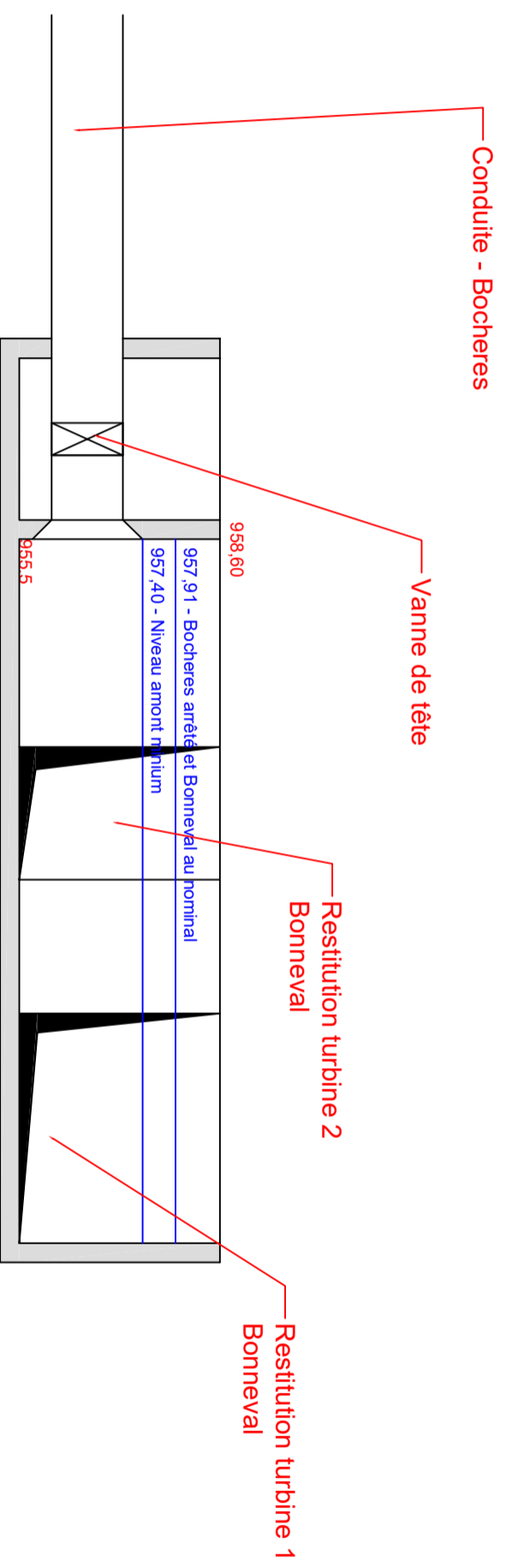

Chambre de mise en charge - Coupe longitudinale

CENTRALE DES BOCHERES		Date : 12 10 2018
		Echelle : 1/100
Chambre de mise en charge Vue de coté et coupe		Plan N° 4 rev 0

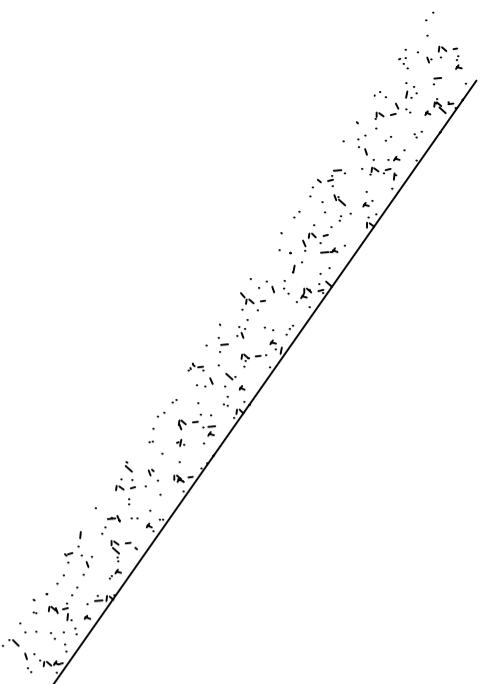

Profil terrain

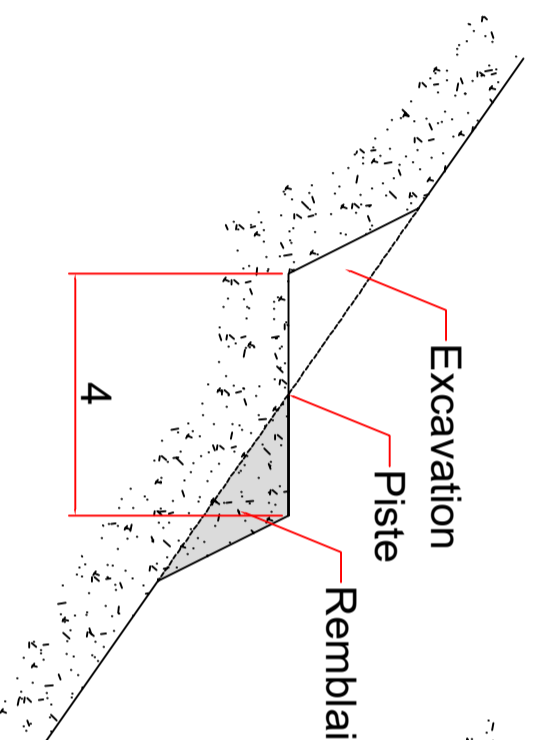

Phase 1 - Création piste

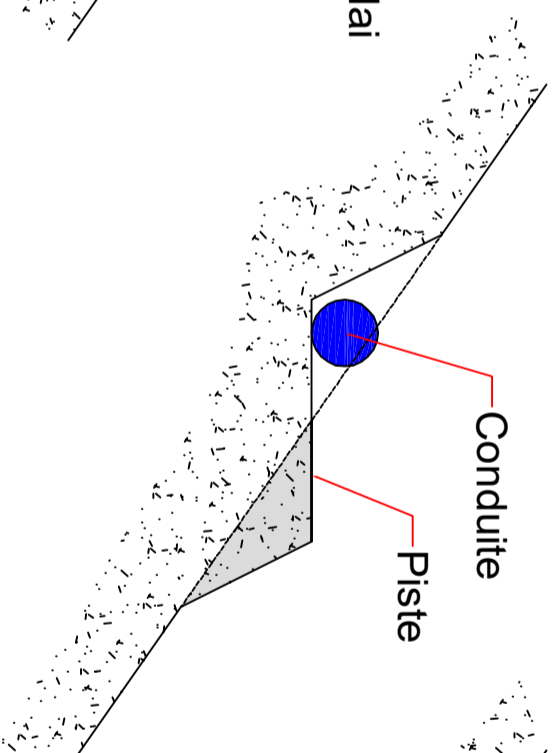

Phase 2 - Pose conduite

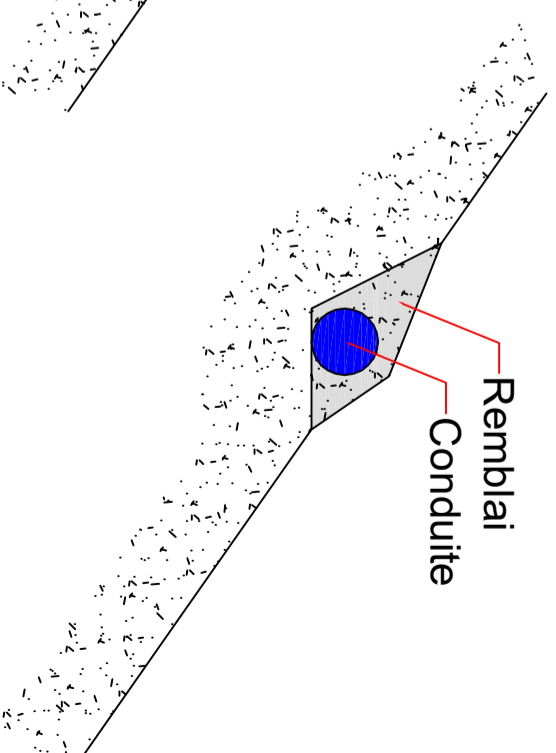

Phase 3 - Conduite enterrée

		Date : 12 10 2018	
CENTRALE DES BOCHERES		Echelle : 1/125	
Profil type		Plan N°5 rev 0	
Implantation de la conduite			

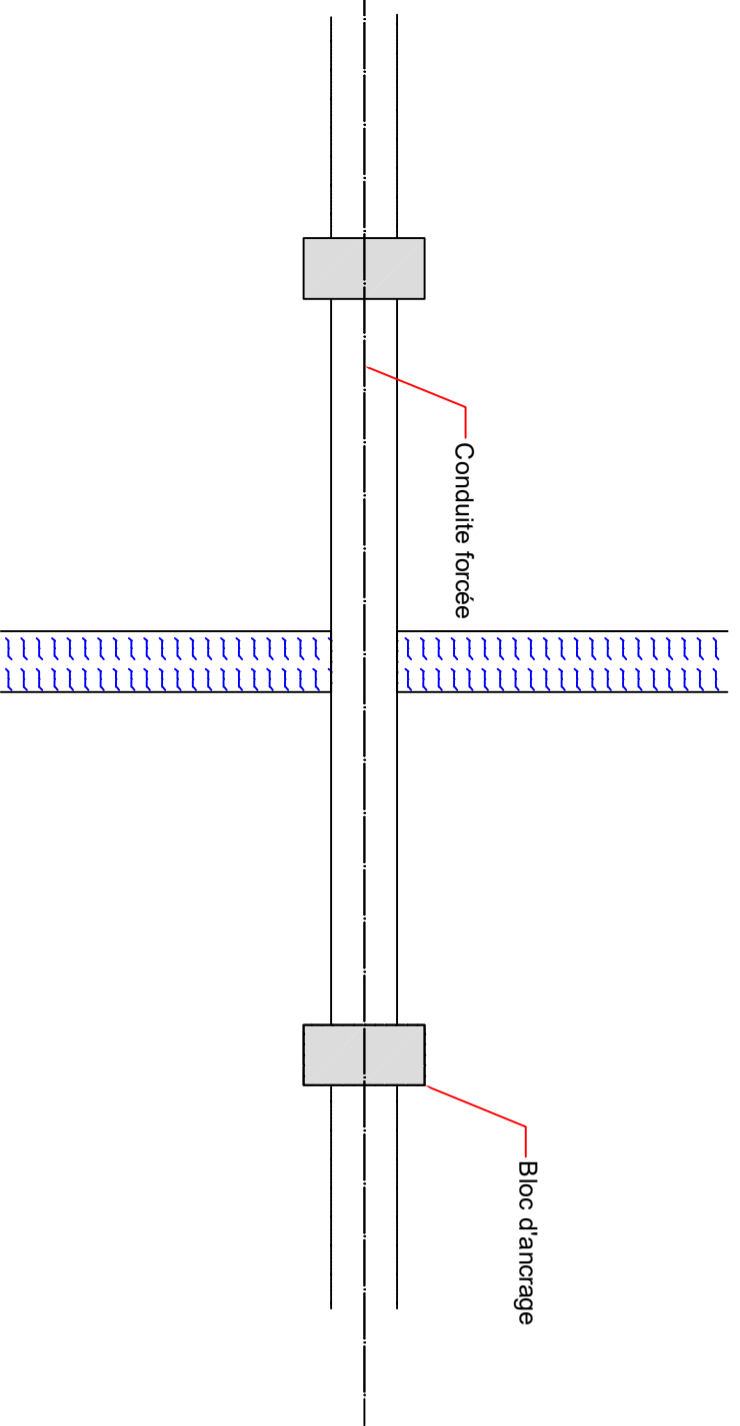

Traversée de la Tailla - Vue de dessus

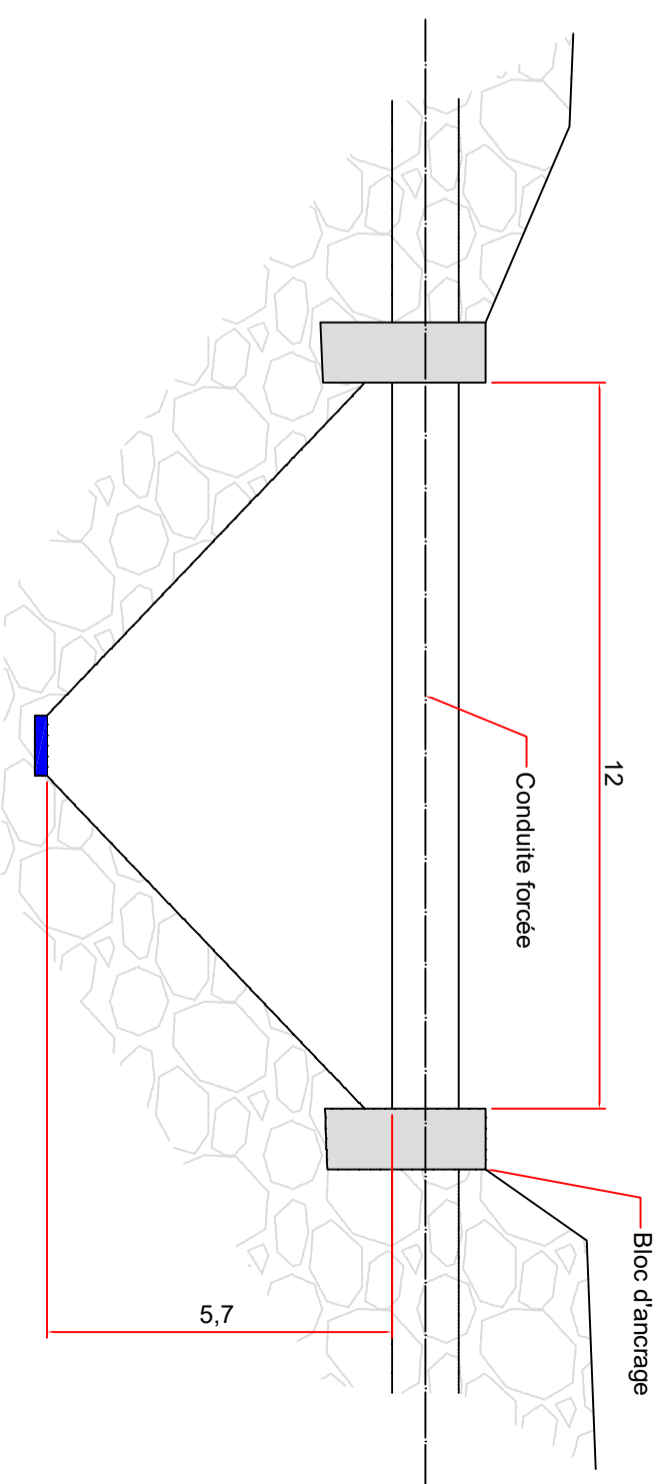

Traversée de la Tailla - Vue de face

		CENTRALE DES BOCHERES	
		Traversée de la Tailla par la conduite forcée	
		Date : 11 10 2018	
		Echelle : 1/250	
		Plan N°6 rev 0	

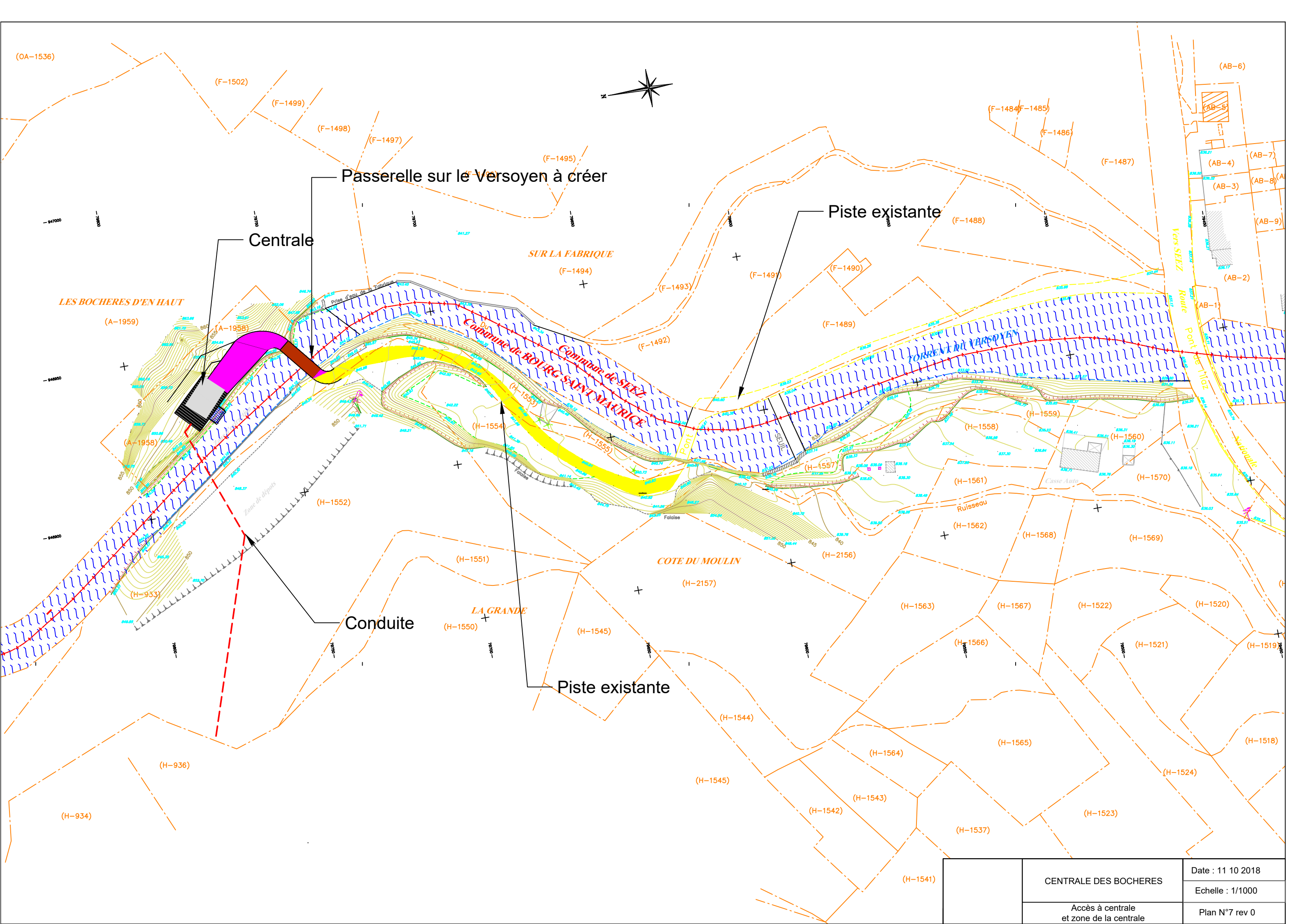

Passerelle sur le Versoyen à créer

Piste existante

Centrale

Conduite

Piste existante

LES BOCHERES D'EN HAUT

SUR LA FABRIQUE

COTE DU MOULIN

LA GRANDE

Commu de BOURG-SAINTE-MARIE

Commu de SEUL

Casse Auto

Vers SEEZ  
Route Pont de l'Iliz

CENTRALE DES BOCHERES

Accès à centrale  
et zone de la centrale

Date : 11 10 2018

Echelle : 1/1000

Plan N°7 rev 0

# S BOCHERES D'EN HAUT

(A--1959)

(A--1958)

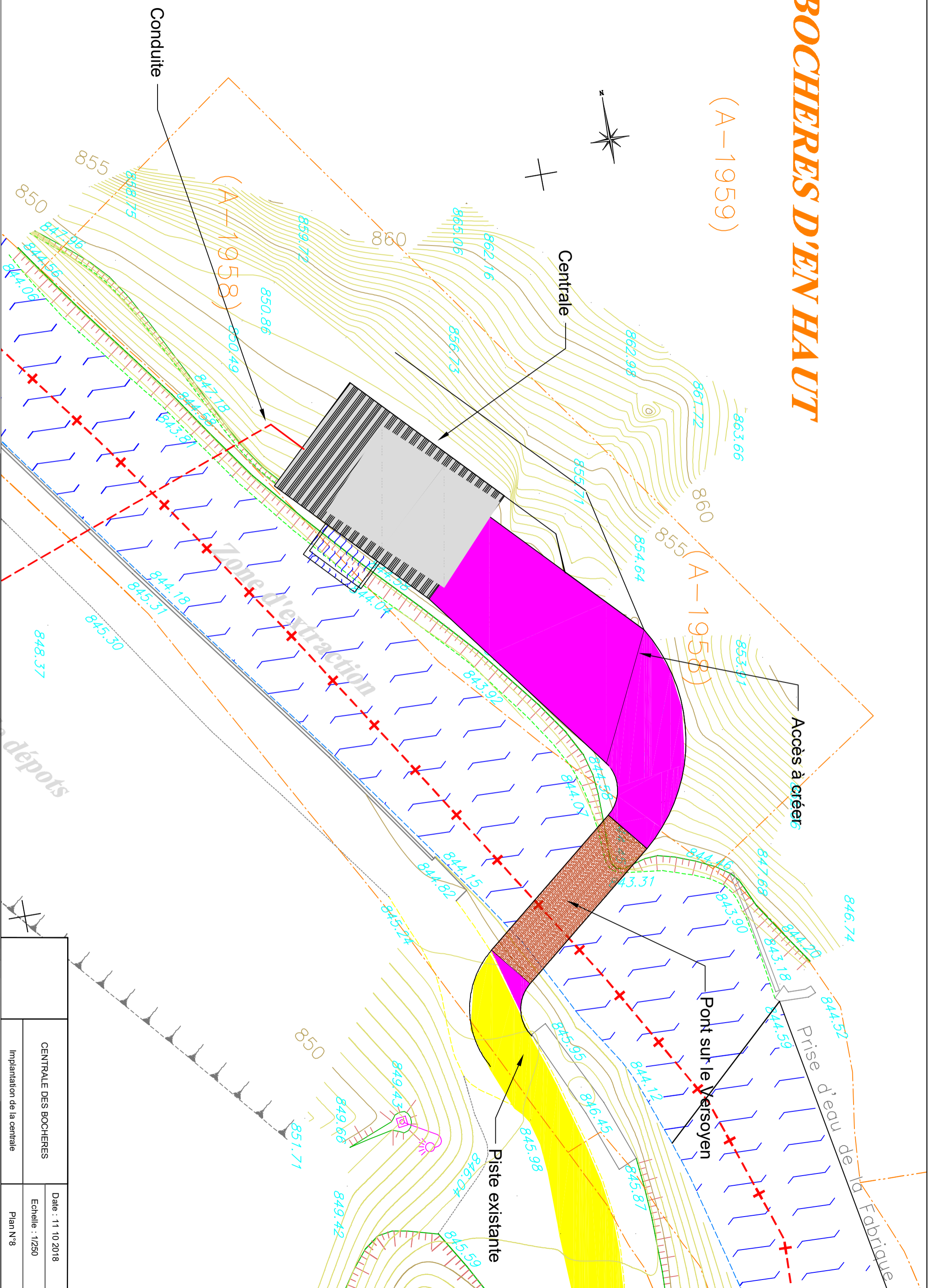

CENTRALE DES BOCHERES		Date : 11 10 2018
Implantation de la centrale		Echelle : 1/250
		Plan N°8



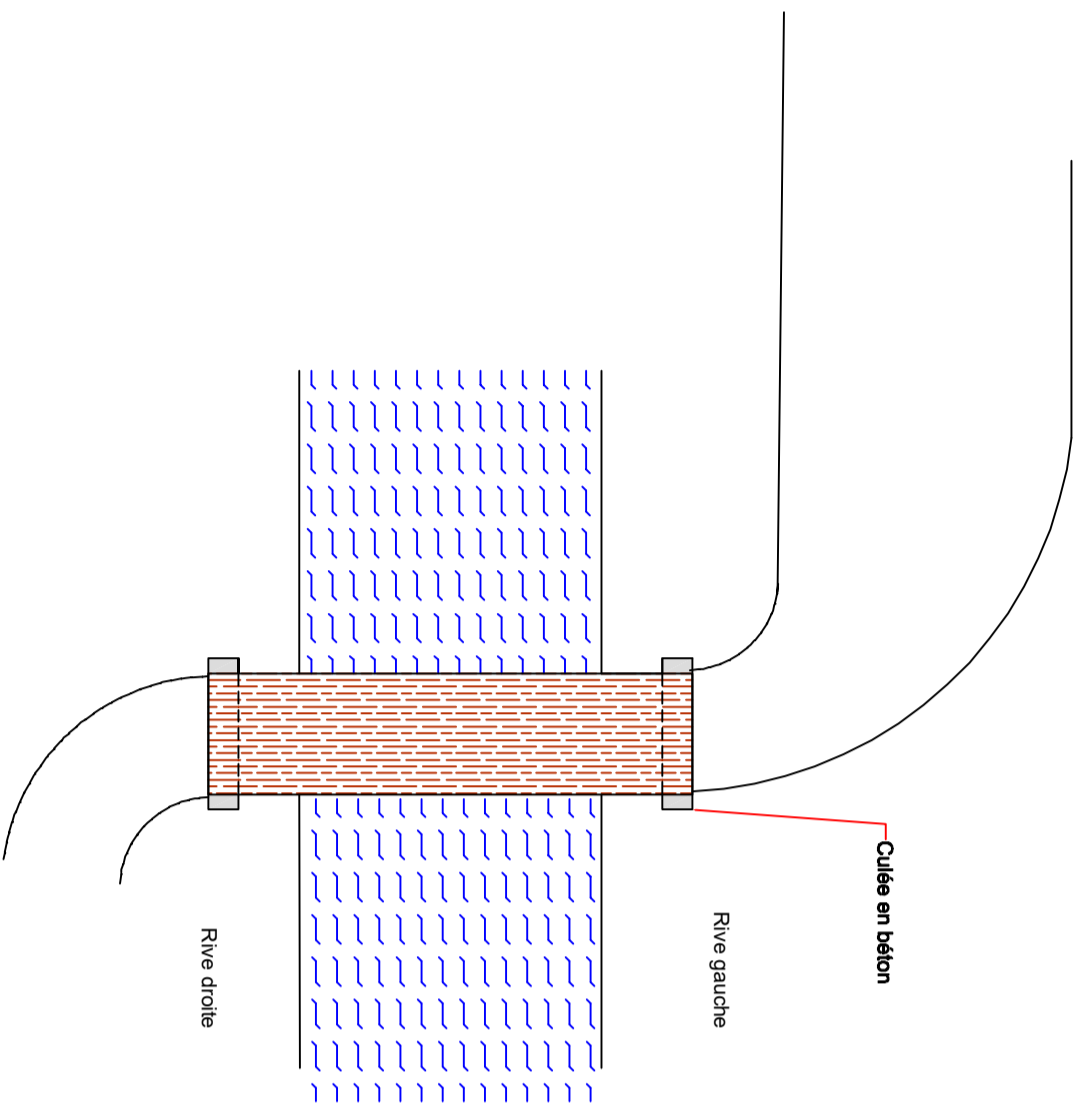

Pont sur le Versoyen - Vue de dessus

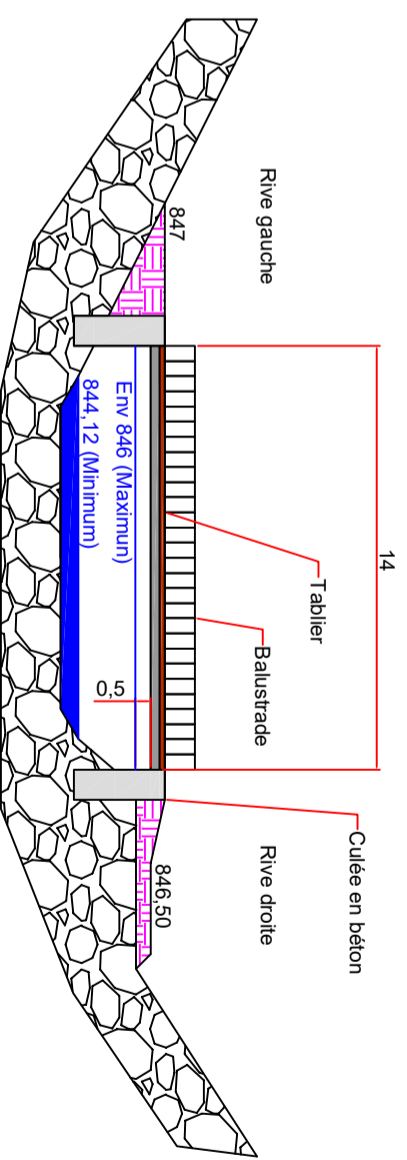

Pont sur le Versoyen - Vue de face

CENTRALE DES BOCHERES		Date : 11 10 2018
Accès à centrale Pont sur le Versoyen		Echelle : 1/125
		Plan N°9 rev 0

Accès à la galerie

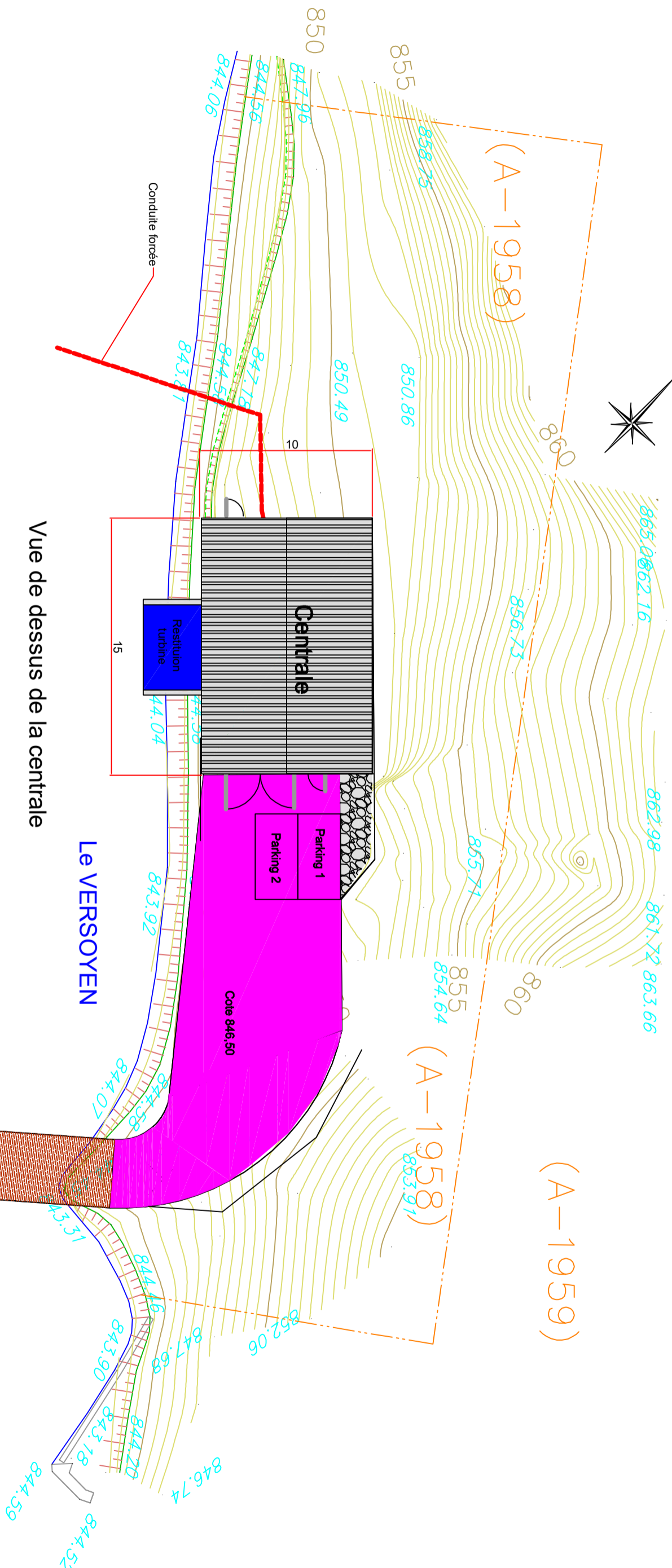
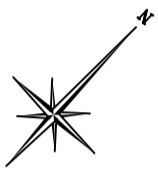

Vue de dessus de la centrale

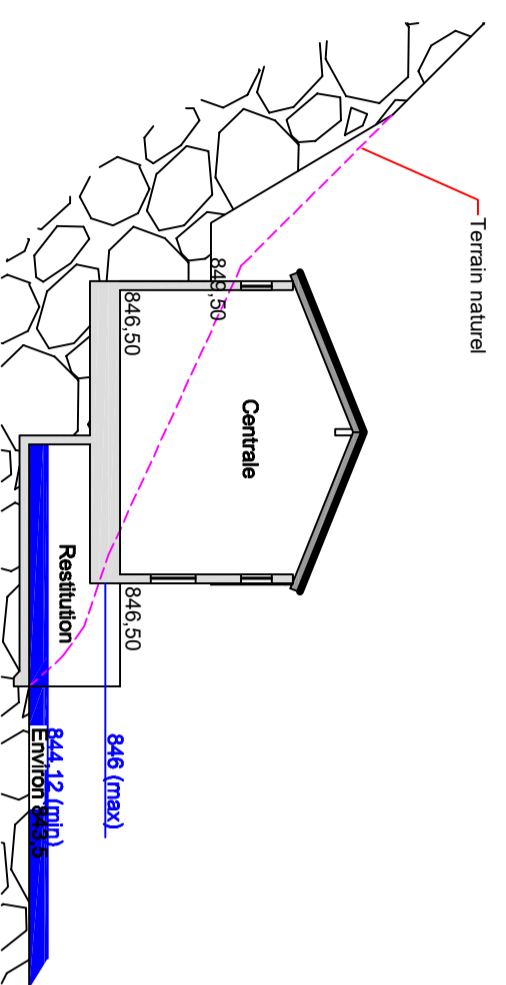

Section transversale de la centrale

CENTRALE DES BOCHERES		Date : 11 10 2018
Vue de dessus de la centrale		Echelle : 1/250
Section de la centrale		Plan N°10 rev 0

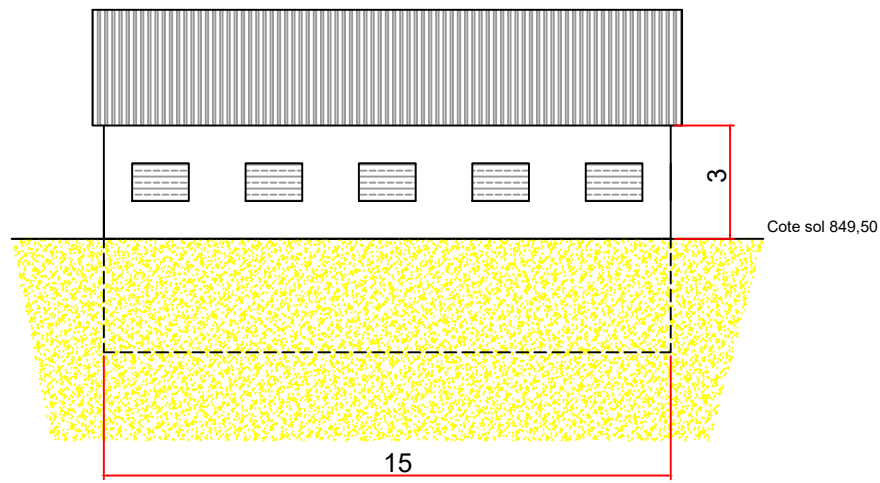

Façade Est - Côté falaise

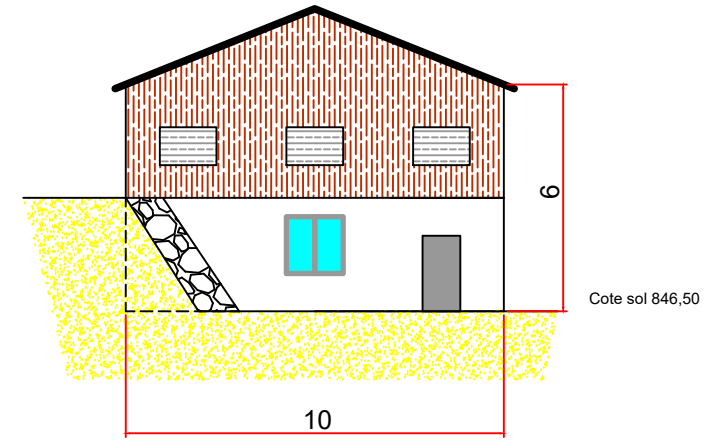

Façade Nord

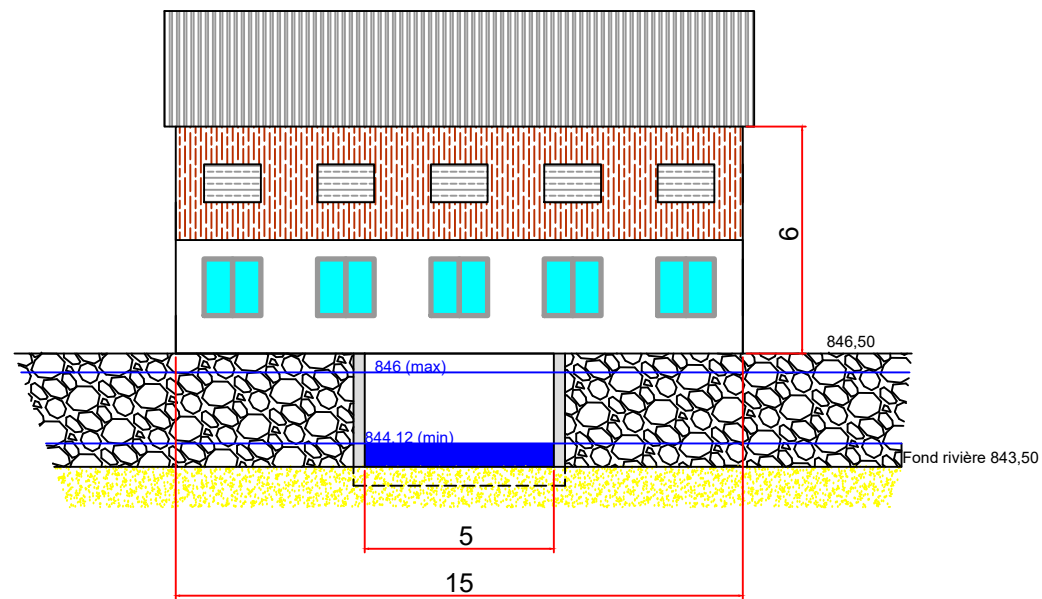

Façade Ouest - Côté Versoyen

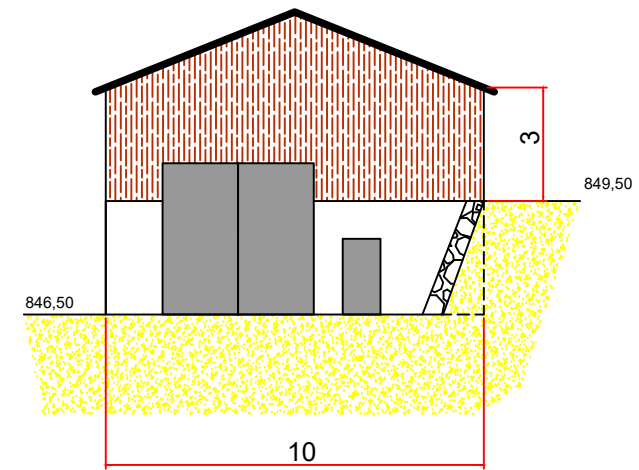

Façade Sud - Côté accès

	CENTRALE DES BOCHERES	Date : 11 10 2018
	Façades de la centrale	Echelle : 1/200
		Plan N°11 rev 0

# Centrale hydroélectrique de Bonneval

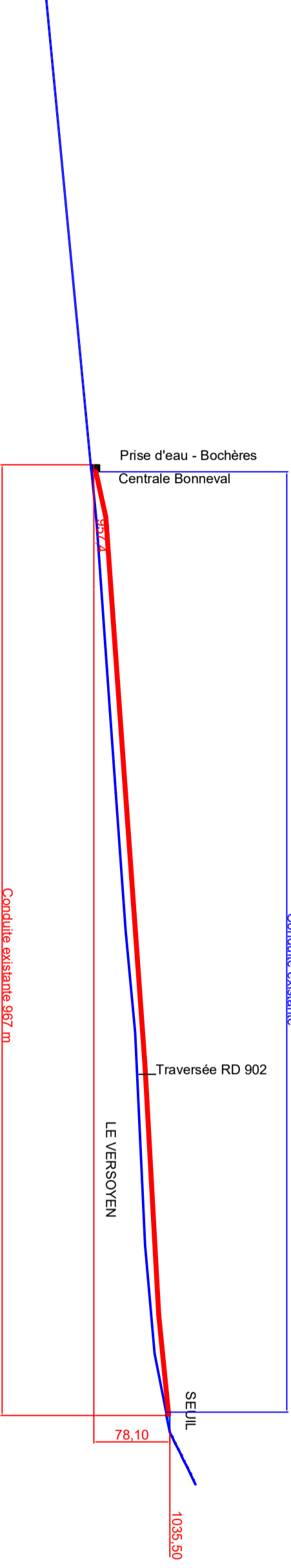

# Centrale hydroélectrique des Bochères

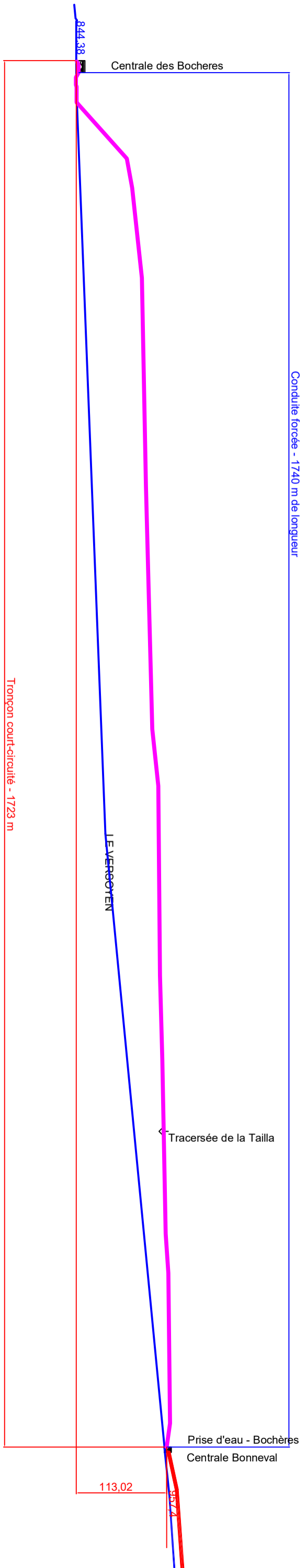

CENTRALE DES BOCHERES		Date : 18 10 2018
Profil en long		Echelle : 1/5000
		Plan N°12 rev 0